

# REMOTE CONTROL RC-EXZ3A

## USER'S MANUAL

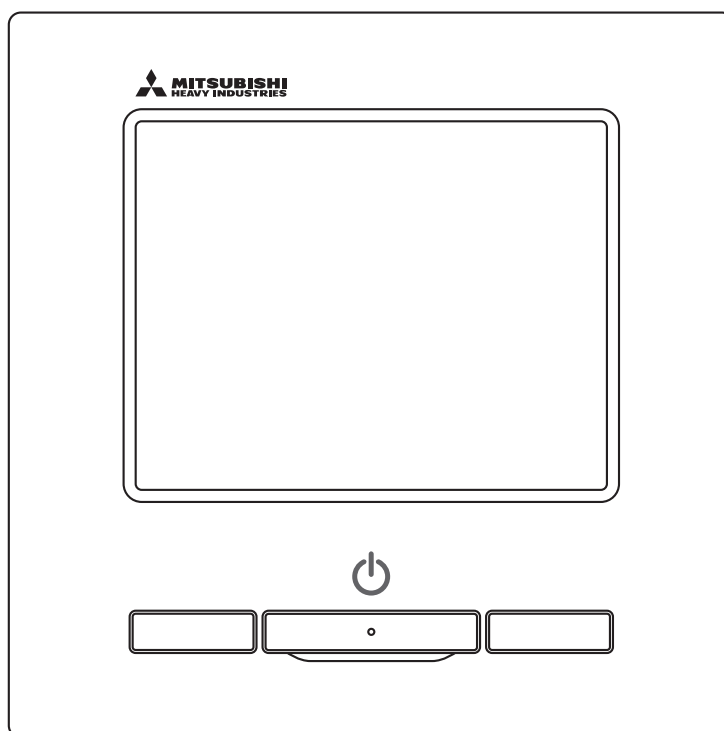

**Thank you very much for your purchasing the REMOTE CONTROL for our packaged air conditioner.**

This user's manual describes cautions for safety. Please read this manual carefully before use in order to operate the unit properly.

Keep this manual, after reading, at a safe place where you can consult it whenever it is necessary.

When the ownership of the unit is changed, please be sure to transfer this manual and the "Installation Manual" to a new owner.

It is not recommended for a user to install or move the unit by the user's own discretion. (Safety or functions may not be assured.)



# Contents

---

<b>1. Before you use</b>	<b>2</b>
Safety precautions	2
Precautions for waste disposal	3
Unit specifications	3
Names and functions of sections on the R/C	4
Menu item	7
<b>2. Menu items</b>	<b>9</b>
Run	9
Stop	9
Change operation mode	10
Change set temp	10
Change flap direction	11
Change the fan speed	14
Zone ON/OFF operation	14
Zone name setting	15
F1/F2 switch operation	16
Anti draft ON/OFF operation	17
High power operation	18
Energy-saving operation	19
<b>3. Quick reference of menu items</b>	<b>20</b>
Quick reference of menu items	20
Restrictions on the sub R/C	22
Operations on menu screens	23
Cautions for each setting screen	24
<b>4. Settings and operations</b>	<b>25</b>
Energy-saving setting	25
Individual flap control	31
Anti draft setting	35
Ventilation operation	37
Initial settings	38
Timer	42
Weekly timer	50
Home leave mode	54
Registering favorite settings	57
Favorite setting operation	58
Administrator settings	59
Silent mode control	72
Select the language	73
Filter sign reset	74
<b>5. Maintenance of unit and LCD</b>	<b>75</b>
Maintenance of unit and LCD	75
<b>6. Useful information</b>	<b>76</b>
Contact company & Error display	76
<b>7. Notice of inspection date</b>	<b>77</b>
<b>8. Message display</b>	<b>77</b>
<b>9. After-sale service</b>	<b>81</b>

## Note

Please turn on the power switch 6 hours before operation to protect the air conditioner (the crank case heater is conducted and the compressor is heated).



Also, be sure not to turn off the power switch (the crank case heater is conducted and the compressor is heated during stop of the compressor. It protect the fault of the compressor caused by liquid refrigerant stagnation).

# 1. Before you use





## Safety precautions

- Please read the precautions written here carefully to operate the unit properly.

You are required to observe these fully because every item of these instructions is important for safety.

 <b>WARNING</b>	Failure to follow these instructions may result in serious consequences such as death, severe injury, etc.
 <b>CAUTION</b>	Failure to follow these instructions may cause injury, property damage or, serious consequences depending on.

- The following pictograms are used in the text.

	Never do.		Always follow the instructions given.
	Absolutely keep water away.		Absolutely keep wet hands away.

- Keep this manual at a safe place where you can consult with whenever necessary. Show this manual to installers when moving or repairing the unit. When the ownership of the unit is transferred, this manual should be given to a new owner.

- **Electrical wiring work must be implemented only by qualified specialists.**

## WARNING



**Consult your dealer or a professional contractor to install the unit.**

Improper installation made on your own may cause electric shocks, fire or dropping of the unit.



**Consult your dealer when moving, disassembling or repairing the unit.  
Never modify the unit.**

Improper handling may result in injury, electric shocks, fire, etc.



**Avoid using combustible substances (hair spray, insecticide, etc) near the unit.**

**Do not use benzene or paint thinner to clean the unit.**

It could cause cracks, electric shocks or fire.



**Stop operation under abnormal situation.**

If continued, it could result in break-down, electric shocks, fire, etc.

If any abnormal condition (burnt odor etc.) occurs, stop operation, turn off the power switch and consult your dealer.



**This appliance can be used by children aged from 8 years and above and persons with reduced physical, sensory or mental capabilities or lack of experience and knowledge if they have been given supervision or instruction concerning use of the appliance in a safe way and understand the hazards involved.**

## CAUTION



**Do not use or let use the unit or remote control as play equipment.**

Improper operations could cause ill health or health disorder.

**Never disassemble the remote control.**

If you touch internal parts accidentally, you could get electric shocks or cause trouble. Consult your dealer when it is necessary to inspect its interior.

**Do not wash the remote control with water or liquid.**

It could cause electric shocks, fire or break-down.

**Do not touch electric parts or operate buttons or screens with wet hands.**

It could cause electric shocks, fire or break-down.

**Do not dispose the remote control by yourself.**

It could destruct the environment. Ask your dealer when it is necessary to dispose the remote control.

### Note

**The remote control should not be installed where it is exposed to direct sunlight or the ambient temperatures become higher than 40°C or lower than 0°C.**

It could cause deformation, discoloration or break-down.

**Do not use benzene, paint thinner, wipes etc. to clean the remote control.**

It could discolor or break-down the remote control. Wipe it with a piece of cloth which is squeezed tightly after wetting with diluted neutral detergent. Finish up the cleaning by wiping with a piece of dry cloth.

**Do not pull or twist the cable of the remote control.**

It could cause break-down.

**Do not tap the remote control buttons or screen with pointed objects.**

It could damage or cause break-down.

## Precautions for waste disposal



Your Air Conditioning product may be marked with this symbol. It means that waste electrical and electronic equipment (WEEE as in directive 2012/19/EU) should not be mixed with general household waste. Air conditioners should be treated at an authorized treatment facility for re-use, recycling and recovery and not be disposed of in the municipal waste stream. Please contact the installer or local authority for more information.

## Unit specifications

Item	Description
Product dimensions	120 (W) x 120 (H) x 19 (D) mm (not including protruded section)
Weight	0.20 kg
Power supply	DC 18 V
Power consumption	0.6 W
Usage environment	Temperature: 0 to 40 °C
Material	Casing: ABS

## Names and functions of sections on the R/C (Operating section)

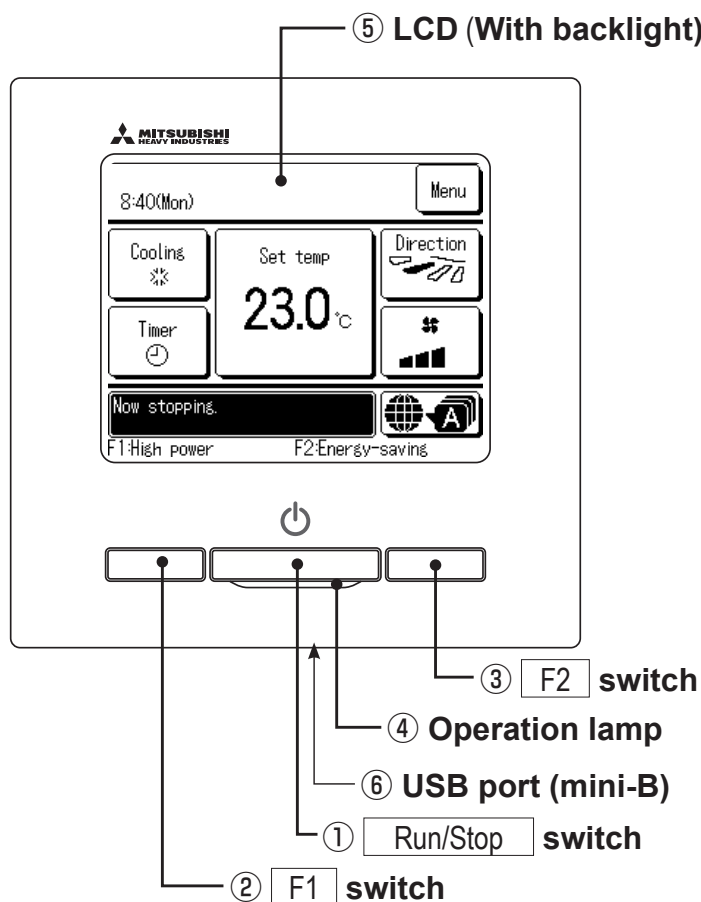

Touch panel system, which is operated by tapping the LCD screen with a finger, is employed for any operations other than the ① Run/Stop, ② F1 ③ F2 switches.

### ① Run/Stop switch

One push on the button starts operation and another push stops operation. (☞ page 9)

### ② F1 switch ③ F2 switch

This switch starts operation that is set in F1/F2 function setting (☞ page 71).  
(☞ page 16)

### ④ Operation lamp

This lamp lights in green (yellow-green) during operation. It changes to red (orange) if any error occurs.

Operation lamp luminance can be changed.  
(☞ page 42)

### ⑤ LCD (With backlight)

A tap on the LCD lights the backlight.  
The backlight turns off automatically if there is no operation for certain period of time.  
Lighting period of the backlight lighting can be

changed. (☞ page 41)

If the backlight is ON setting, when the screen is tapped while the backlight is turned off, the backlight only is turned on. (Operations with switches ①, ② and ③ are excluded.)

### ⑥ USB port

USB connector (mini-B) allows connecting to a personal computer.

For operating methods, refer to the instruction manual attached to the software for personal computer (remote control utility software).

### Note

- When connecting to a personal computer, do not connect simultaneously with other USB devices.  
Please be sure to connect to the computer directly, without going through a hub, etc.

## Names and functions of sections on the R/C (Display)

\*All icons are shown for the sake of explanation.

### TOP screen

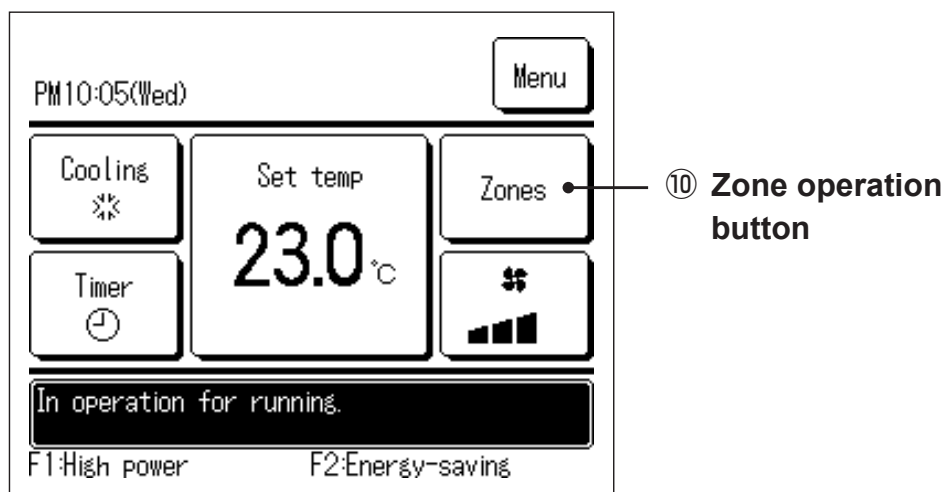
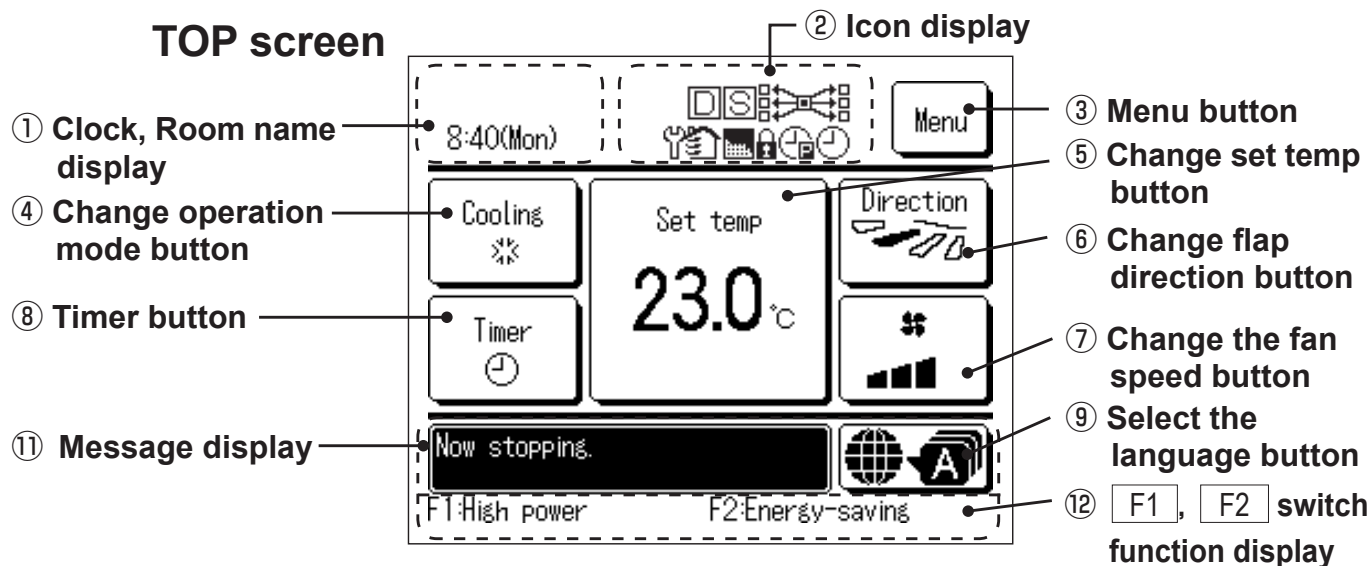



### ① Clock, Room name display

Displays the current time and the room name.

### ② Icon display

Each icon is displayed when one of following settings is going on.

 When the demand control is effective.

 When setting is made from the sub R/C.

 When the central control (Optional) is running.

 When the periodical inspection is necessary.

 During the ventilation operation.

 When "filter sign" is up.

 When the Permission/Prohibition setting is made.

 When the peak-cut timer is set.

 When the weekly timer is set.

### ③ Menu button

When setting or changing other than the following ④-⑧, tap the menu button. Then menu items are displayed, select one and set.

### ④ Change operation mode button

Displays the operation mode which is selected currently. Tap this button to change the operation mode.

### ⑤ Change set temp button

Displays the temperature which is set currently. Tap this button to change the set temperature.

### ⑥ Change flap direction button

Displays the flap direction which is selected currently. When the 3D auto flow operation is enabled, 3D auto display will appear. Tap this button to change the flap direction.

### ⑦ Change the fan speed button

Displays the fan speed which is selected currently. Tap this button to change the fan speed.

### ⑧ Timer button

Displays simplified contents of the timer which is set currently.  
(When two or more timers are set, contents of the timer which will be operated immediately after is displayed.)  
Tap this button to set the timer.

### ⑨ Select the language button

Select a language to be displayed on the R/C.

### ⑩ Zone operation button

Tap this button to go to the zone operation screen.

### ⑪ Message display

Status of air conditioner operation and messages of the R/C operations etc. are displayed.

### ⑫ switch function Display

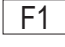
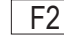
Displays the function that is set for each ,  switch.

The function for these switches can be changed in F1/F2 function setting.



# Menu item

## Main menu

### Basic operation

Run .....	9
Stop.....	9
Change operation mode .....	10
Change set temp .....	10
Change flap direction .....	11
Change the fan speed .....	14
Zone ON/OFF operation .....	14
Zone name setting.....	15
F1, F2 switch operation.....	16
Anti draft ON/OFF operation .....	17
High power operation .....	18
Energy-saving operation .....	19

### Useful functions

Individual flap control.....	31
Anti draft setting.....	35
Timer .....	42
Set ON timer by hour .....	44
Set OFF timer by hour .....	46
Set ON timer by clock .....	47
Set OFF timer by clock .....	49
Confirm.....	50
Favorite setting .....	57
Weekly timer .....	50
Home leave mode .....	54
External ventilation .....	37
Select the language .....	73
Silent mode control .....	72

### Energy-saving setting

Sleep timer .....	25
Peak-cut timer .....	26
Automatic temp set back .....	29
Motion sensor control .....	30

### Filter

Filter sign reset .....	74
-------------------------	----

### User setting

Initial settings .....	38
Clock setting .....	38
Date & time display .....	39
Summer time .....	40
Contrast .....	40
Backlight .....	41
Controller sound .....	41
Operation lamp luminance .....	42
Administrator settings .....	59
Permission/Prohibition setting .....	60
Outdoor unit silent mode timer .....	61
Setting temp range .....	62
Temp increment setting .....	64
Set temp display .....	64
R/C display setting .....	65
Change administrator password .....	70
F1/F2 function setting .....	71

<b>Main menu</b>	
<b>Service setting</b>	
Installation settings	
Installation date .....	Please refer to the installation manual.
Company information .....	
Test run .....	
Duct unit settings .....	
Change auto-address .....	
Address setting of main IU .....	
IU back-up function .....	
Motion sensor setting .....	
R/C function settings	
Main/Sub of R/C .....	Please refer to the installation manual.
Return air temp .....	
R/C sensor .....	
R/C sensor adjustment .....	
Operation mode .....	
°C / °F .....	
Fan speed .....	
External input .....	
Upper/lower flap control .....	
Left/right flap control .....	
Ventilation setting .....	
Auto-restart .....	
Auto temp setting .....	
Auto fan speed .....	
IU settings	
Fan speed setting .....	Please refer to the installation manual.
Filter sign .....	
External input 1 .....	
External input 1 signal .....	
External input 2 .....	
External input 2 signal .....	
Heating thermo-OFF temp adjustment .....	
Return temperature adjustment .....	
Fan control in cooling thermo-OFF .....	
Fan control in heating thermo-OFF .....	
Anti-frost temp .....	
Anti-frost control .....	
Drain pump operation .....	
Keep fan operating after cooling is stopped .....	
Keep fan operating after heating is stopped .....	
Intermittent fan operation in heating .....	
Fan circulator operation .....	
Control pressure adjust .....	
Auto operation mode .....	
Thermo. rule setting .....	
Auto fan speed control .....	
IU overload alarm .....	
External output setting .....	
Service & Maintenance	
IU address .....	Please refer to the installation manual.
Next service date .....	
Operation data .....	
Error display .....	
Saving IU settings .....	
Special settings .....	
Indoor unit capacity display .....	
<b>Contact company</b>	
Contact company .....	76

## 2. Menu items

### Run

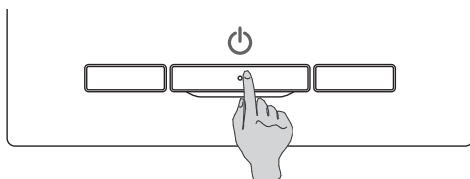

Push the **Run/Stop** switch.

Operation lamp (green) lights and operation starts.

### Stop

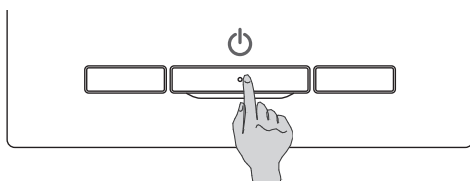

Press the **Run/Stop** switch while the unit is in operation.

The operation lamp turns off and the operation stops.

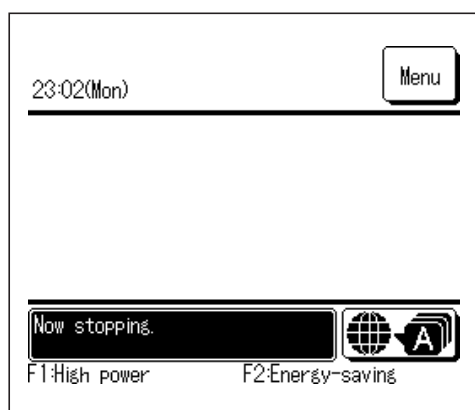

When the operation stops, all operation buttons on the screen turn off.

When the set lighting time of backlight (page 41) is counted up, the backlight turns off.

When the screen is tapped, the backlight lights, and all operation buttons are displayed.

#### Note

- Do not shut down the power supply immediately after the stop of operation. It should be waited for more than 5 minutes till the residual operation time of drain motor is counted up. Otherwise, it could cause water leakage or breakdown.

### Advice

- A message "Invalid request" may be displayed when a button is pushed. This is not a fault but it is because the button operation is set to the "Disable". (page 60)
- The unit starts to operate initially with the following settings after the power on. These settings can be changed as desired.

Central control	..... OFF
Operation mode	..... With auto mode: Auto cooling
	..... Without auto mode: Cooling
Set temp	..... 23.0°C
Fan speed	..... 3-speed
Flap direction	..... When cooling: position 2, when heating: position 3 (page 11)

\*When an FDK with a left/right flap is connected, left/right flap direction: center, 3D AUTO: disabled
- In the following cases, a message "Operation mode is invalid." is displayed and it changes to the fan operation, because operation modes are not matched.
  - ① When Heating (including auto heating) is selected for Operation mode while using an OU for cooling only.
  - ② When Heating is selected for Operation mode while controlling multiple units including units allowed for both cooling and heating and units for cooling only.
  - ③ When different operation modes are selected between IUs which are connected to a OU that do not allow mixed operation of cooling and heating.

## Change operation mode

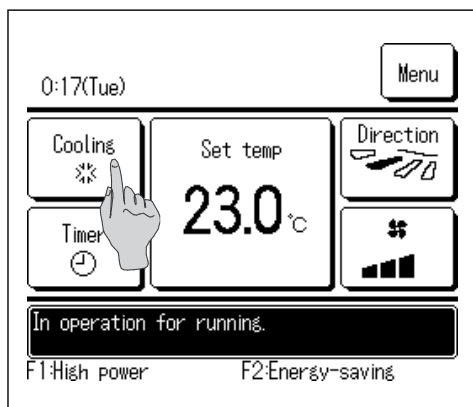

- 1 Tap the **Change operation mode** button on the TOP screen.

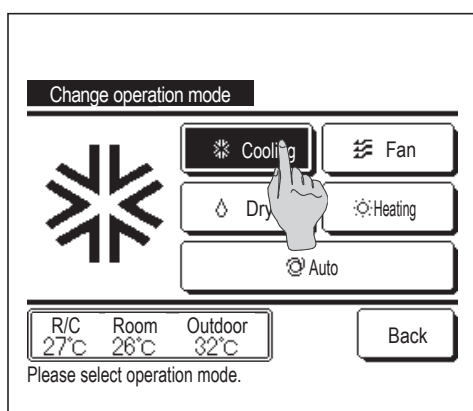

- 2 When the Change operation mode screen is displayed, tap the button of desired mode.

The operation mode changes, and the display returns to the TOP screen.

Icons displayed have the following meanings.

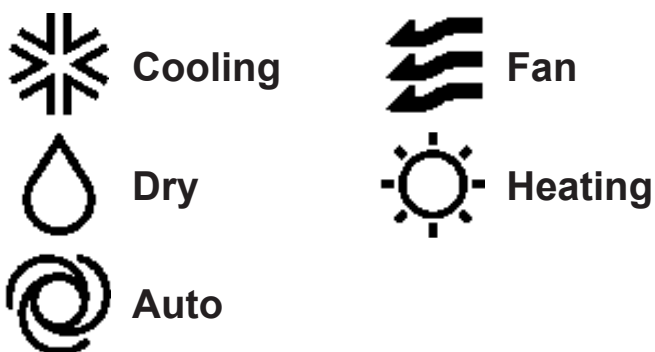

- Operation modes which cannot be selected depending on combinations of IU and OU are not displayed.
- When the Auto is selected, the cooling and heating switching operation is performed automatically according to indoor and outdoor temperatures.

## Change set temp

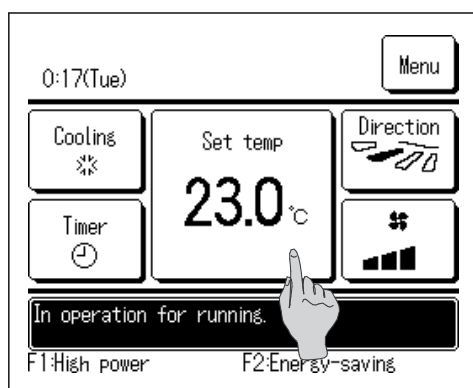

- 1 Tap the **Change set temp** button on the TOP screen.

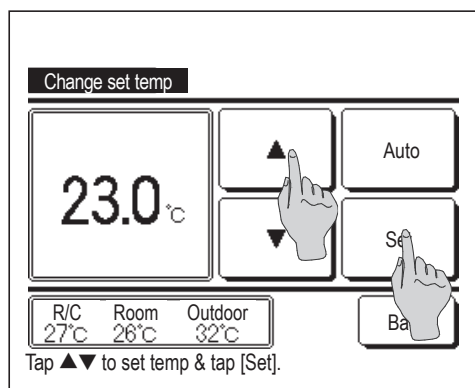

- 2 When the Change set temp screen is displayed, select the temperature as desired with using buttons.
- 3 After selecting the set temp, tap the button. The display returns to the TOP screen.

■ For allowable temperature setting ranges, refer to the range setting of set temp (page 62).

■ Reference set temp

Cooling ... 26 to 28°C

Dry ... 24 to 26°C

Heating ... 20 to 24°C

Fan ... Setting temp is not required.

■ If the is selected for the set temp, the set temp display shows "0".

Temperature can be adjusted higher or lower with using buttons. Note that is not displayed and cannot be set when SC-SL2, SC-SL3, or SC-SL4 is connected.

■ If the button is tapped without tapping the button, the selected set temp is invalidated and the display returns to the TOP screen.

## Change flap direction

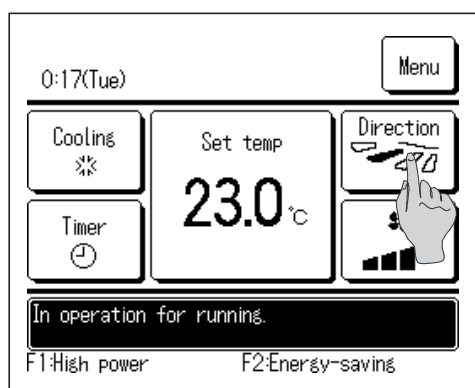

- 1 Tap the button on the TOP screen.

When an FDK with a left/right flap is not connected: 2

When one or more FDKs with a left/right flap are connected: 3

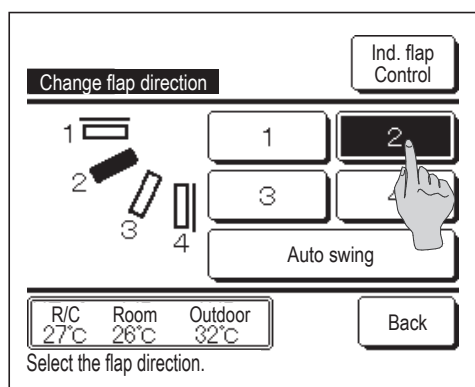

- 2 When the Change flap direction screen is displayed, tap the button of desired flap direction.

To swing the flap, tap the button.

To fix the flap position, tap one of to buttons.

After selecting the flap direction,

When an FDK with a left/ right flap is not connected, the display returns to the TOP screen. ( 1)

When an FDK with a left/right flap is connected, the display returns to the Select flap screen. ( 3)

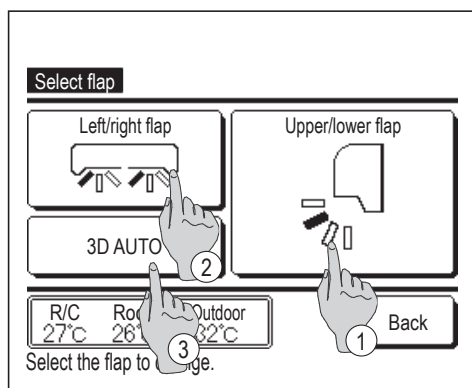

**3** When one or more FDKs with a left/right flap are connected, the Select flap screen is displayed. Select the desired flap direction.

- ① To change the up/down flap direction, tap the **Upper/lower flap** button. The Change flap direction screen for the up/down flap is displayed. (➡ 2)
- ② To change the left/right flap direction, tap the **Left/right flap** button. The Change flap direction screen for the left/right flap is displayed. (➡ 4)
- ③ The 3D auto flow operation automatically controls the fan speed and flap direction to efficiently condition the air of the entire room. To switch to the 3D auto flow operation, tap **3D AUTO** to enable the operation.  
  
To disable the 3D auto flow operation, tap the **3D AUTO** again. The flap direction returns to the direction that was set before the 3D auto flow operation was enabled. The 3D auto flow operation will also be disabled when you change the up/down or left/right flap direction during the 3D auto flow operation.

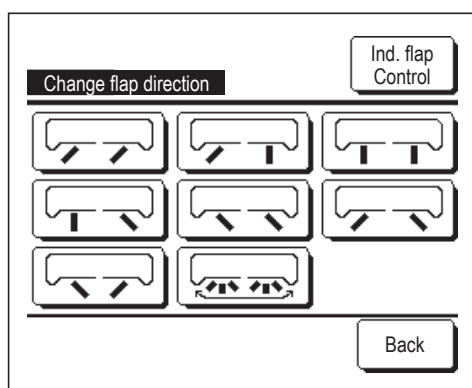

**4** Tap the desired flap direction. After selecting the flap direction, the display returns to the Select flap screen. (➡ 1)

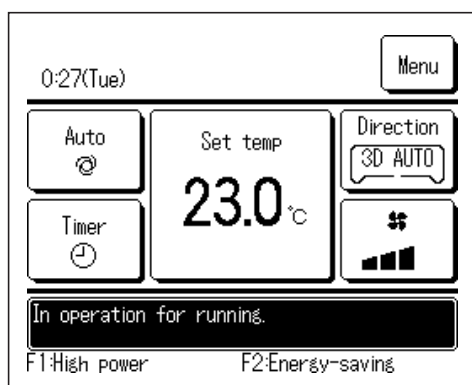

**5** When the 3D auto flow operation is enabled, "3D AUTO" is displayed on the **Change flap direction** button, as shown on the left.

---

■ When multiple IUs are connected to the remote control for a mixed environment consisting of FDKs with a left/right flap and IUs without a left/right flap, enabling the 3D auto flow operation will set the models without a left/right flap to a flap position set before the 3D auto flow operation was started.

■ Since the flap is controlled automatically in the following operation, it may differ from the display on the R/C.

- When the room temperature is higher than the set temp (In case of the heating operation)
- When the "In operation for heating standby." or "In operation for defrosting." is displayed (In case of the heating operation).  
Cool air is blown horizontally not to blow directly to human body.
- In a high humidity environment (during cooling operation)

■ When you select Auto swing while the Anti draft setting (🔍 page 35) is enabled, the flap will not swing and be set at flap position 1.

■ Changing the left/right flap direction and 3D auto flow operation cannot be performed from the SC-SL2, SC-SL3, or SC-SL4. Also note that 3D auto flow operation will not be disabled when you change the flap direction from the SC-SL2, SC-SL3, or SC-SL4 during a 3D auto flow operation.

#### Note

- Do not manually move the flaps or panel with anti draft by force. It could damage these flaps and panels.
- Do not blow air downward for a long period of time during the cooling operation. Condensation may be generated and water may drip from the side panel. (In case of Ceiling suspended type)
- For FDKs with a left/right flap, it is recommended that the flap should be set toward the right side when there is a wall on the left, or set toward the left side when there is a wall on the right. For more information, refer to the Notes in the Individual flap control section (🔍 page 33).

## Change the fan speed

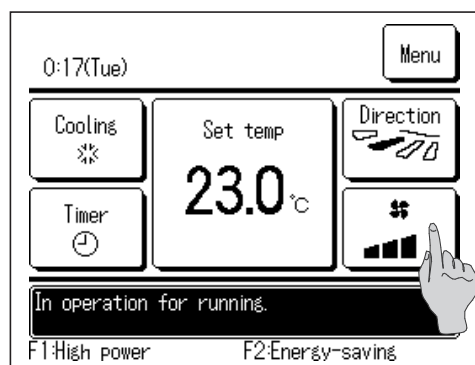

1 Tap the **Change the fan speed** button on the TOP screen.

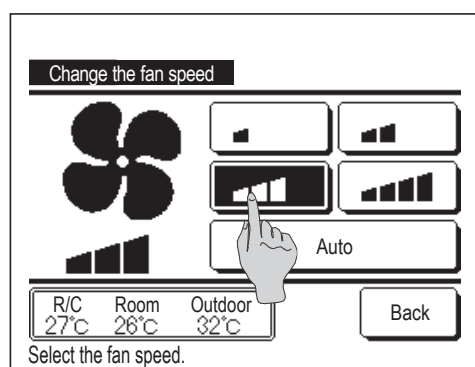

2 When the Change the fan speed screen is displayed, tap the button of desired fan speed.

After setting the fan speed, the display returns to the TOP screen.

■ Fan speeds which can be set vary depending on the models of IU.

■ When the **Auto** is selected, the fan speed is changed automatically depending on the capacity.

Note that **Auto** is not displayed and cannot be set when SC-SL2 or SC-SL3 is connected.

## Zone ON/OFF operation (for zone control)

The "Zones" button appears on the TOP screen when zone settings were performed by **Menu** ⇒ **Service setting** ⇒ **Installation setting** ⇒ **Duct unit setting** ⇒ **Zone setting**.

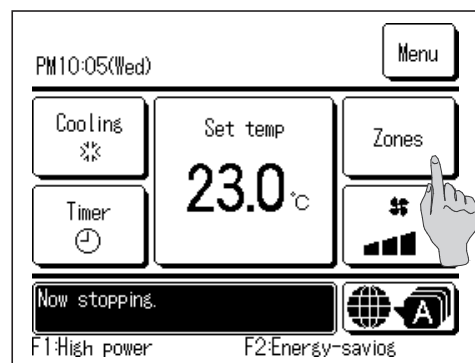

Tap the **Zones** button.

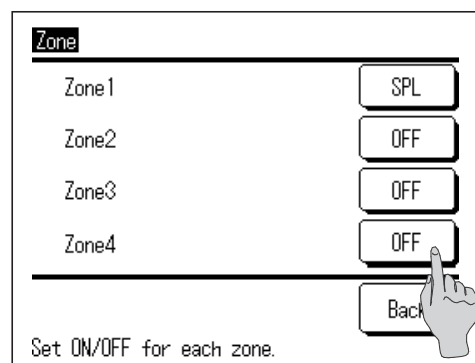

Sets **ON** / **OFF** (OPEN/CLOSE) for each zone.



\*1: If there is no common zone, the spill zone is OFF, and one or more other zone are OFF, the spill zone will open automatically and **SPL** will be displayed.

### Advice

Common zone: A zone in which a damper is not installed. Spill zone: A zone in which a damper open automatically.



## Zone name setting (for zone control)

**User setting**

Initial settings

Administrator settings

Back

Select the item.

- 1 Tap the **Menu** button on the TOP screen and select **User setting** ⇒ **Administrator settings**.

The administrator password input screen is displayed.  
Enter the administrator password.

**Administrator settings**

R/C display setting

Change administrator password

F1/F2 function setting

Previous

Back

Select the item.

- 2 When the administrator setting menu is displayed, select **R/C display setting** ⇒ **Zone name**.

**R/C display setting**

Defrost operation display

Auto cooling/heating display

Display temp of R/C, Room, Outdoor

Zone name

Previous

Back

Select the item.

**Zone name**

Zone1

Zone2

Zone3

Zone4

Back

Select the zone you want to change the name

- 3 Tap the zone you want to set a zone name for.

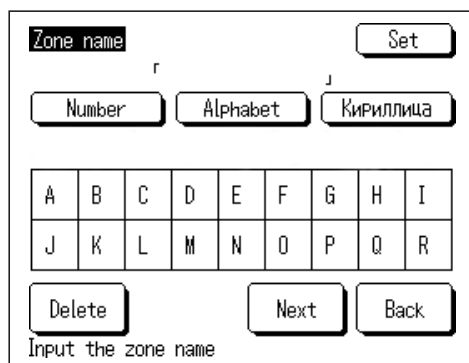

Zone name Set

Number Alphabet Кириллица

A	B	C	D	E	F	G	H	I
J	K	L	M	N	O	P	Q	R

Delete Next Back

Input the zone name

#### 4 The zone name input screen is displayed.

The zone name can be set with up to 8 2-byte letters (16 1-byte letters).

You can enter alphanumeric or Cyrillic.

Tap the **Back** or **Next** button to display next character group.

When you have finished inputting the room name, tap **Set**.

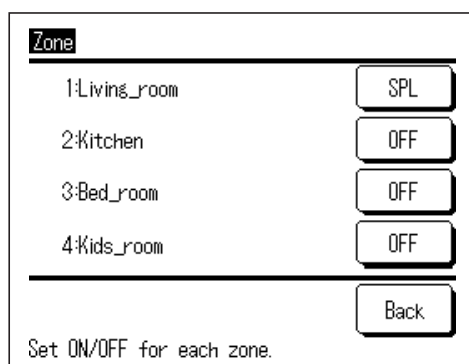

Zone

1:Living_room	SPL
2:Kitchen	OFF
3:Bed_room	OFF
4:Kids_room	OFF

Back







Set ON/OFF for each zone.

#### 5 The zone name that was set is displayed on the zone operation screen.

## F1/F2 switch operation

You can set any of the following functions to the **F1** and **F2** switches.

The **F1** / **F2** switches act as shortcuts; it can be much easier and faster than starting an operation from the usual **Menu** on the TOP screen.

- High power operation ...  page 18
- Energy-saving operation ...  page 19
- Silent mode control ...  page 72
- Home leave mode ...  page 54
- Favorite setting operation ...  page 58
- Filter sign reset ...  page 74
- Anti draft ON/OFF ...  page 17

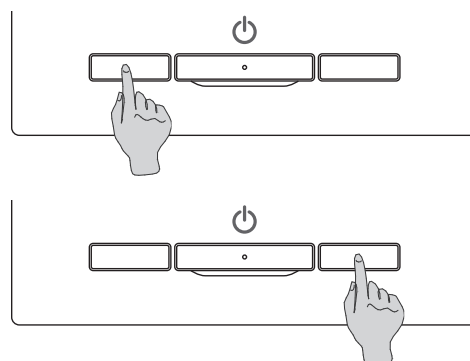

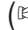
Changing the function of the **F1** or **F2** switch can be performed with the F1/F2 function setting ( page 71).

The following functions are set as factory settings.

You may change these settings as desired.

- F1** switch ...High power operation
- F2** switch ...Energy-saving operation

### Advice

- When using a standard FDT/FDTC panel (a panel without anti draft function), set functions other than the Anti draft ON/OFF function to the **F1** and **F2** switches. F1/F2 function setting ( page 71)
- If anti draft is turned on (operated) during the use of a standard FDT/FDTC panel, louvers may not automatically swing, which is not a malfunction.

## Anti draft ON/OFF operation (for using panel with anti draft)

Anti draft can be turned ON/OFF (operated/stopped) with a single tap of the button.

To turn ON/OFF the anti draft with the **F1** or **F2** switch, the anti draft ON/OFF function needs to be preset to the **F1** or **F2** switch. (☞ page 71)

Initially, Anti draft ON/OFF or high power operation is set to the **F1** switch. (It is automatically determined according to the connected indoor unit.)

■ When the sub R/C is set, Anti draft ON/OFF setting cannot be used.

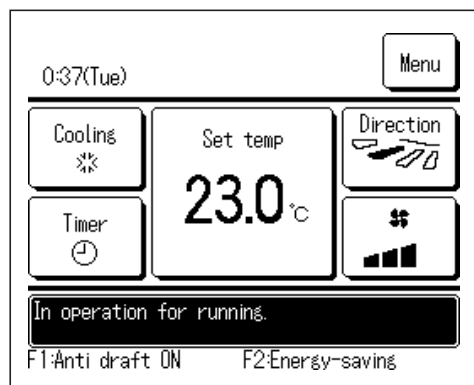

- 1 Push the **F1** ( **F2** ) switch. Anti draft is turned ON (operated). "Anti draft ON" is displayed in the **F1** ( **F2** ) switch function display area.

- The enabled operation mode and the enabled anti draft of the blow outlets operate based on the details set in the Anti draft setting.
- If anti draft is turned on (operated) during the use of the standard FDT, FDT/C panel, louvers may not automatically swing, which is not a malfunction.
- While the unit is stopped, anti draft does not operate even when "Anti draft ON" is displayed. Anti draft will operate when you press the **Run/Stop** switch to start the unit operation.
- If no indoor unit equipped with anti draft function is connected, a message "Invalid request." is displayed on the R/C screen.
- Depending on how the Permission/Prohibition setting (☞ page 60) is set, the administrator password input screen may be displayed.

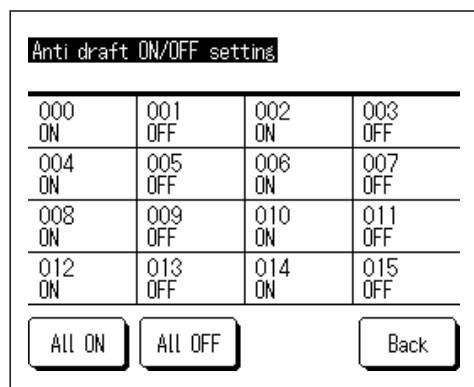

- 2 Press the **F1** ( **F2** ) switch. Anti draft is turned OFF (stopped). "Anti draft OFF" is displayed in the **F1** ( **F2** ) switch function display area.

- 3 When two or more indoor units equipped with anti draft function are connected to the R/C, the indoor unit No. and the ON/OFF state of each anti draft are displayed by pressing the **F1** ( **F2** ) switch. Set ON or OFF for each indoor unit.

Anti draft is turned OFF by tapping ON and turned ON by tapping OFF.

All of the connected indoor units that are equipped with anti draft function are turned ON by pressing the **All ON** button.

All of the connected indoor units that are equipped with anti draft function are turned OFF by pressing the **All OFF** button.

In the **F1** ( **F2** ) switch function display area, the anti draft ON/OFF state of the indoor unit that has the smallest address among the indoor units equipped with anti draft function is displayed.

## High power operation

The high power operation adjusts the room temperature quickly to a pleasant level by increasing the operation capacity.

The high power operation continues for 15 minutes at the maximum and returns to the normal operation automatically.

When the operation mode is changed, the high power operation returns to the normal operation, too.

High power operation must be set to the **F1** or **F2** switch (→ page 71).

High power operation is set to the **F1** switch as the factory setting.

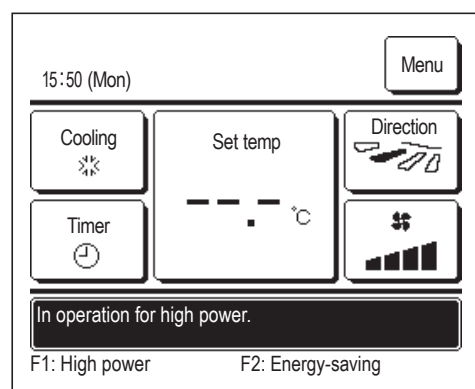

**1** Push the **F1** ( **F2** ) switch to start the high power operation.

■ Operation will start when the **F1** ( **F2** ) switch is pushed, even if **Run/Stop** switch is off.

■ High power operation is only allowed when Heating or Cooling is selected for the operation mode.

Message “In operation for high power.” is displayed on the R/C screen, and “—, —°C” is displayed on the Set temp button during the high power operation.

■ Set temp and change fan speed operations are disabled during high power operation.

**2** High power operation is terminated when you perform one of the following.

- When you terminate through a **Run/Stop** operation
- When you change the operation mode
- When 15 minutes have elapsed since the high power operation started
- When you terminate the high power operation with the **F1** ( **F2** ) switch

## Energy-saving operation

Use this operation to save energy. Set temp is fixed at 28°C in the cooling operation or 22°C in the heating operation. Since the capacity is controlled automatically based on the outdoor temperature, energy can be saved without losing comfort.

Energy-saving operation must be set to the **F1** or **F2** switch (→ page 71)

Energy-saving operation is set to the **F2** switch as the factory setting.

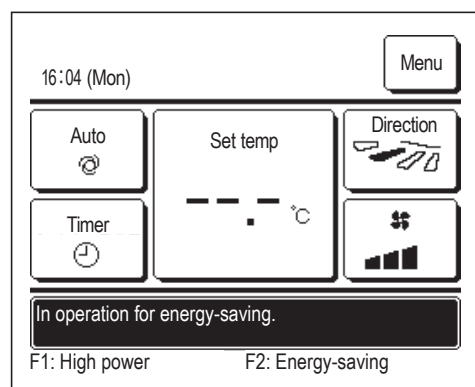

**1** Push the **F1** ( **F2** ) switch to start the energy-saving operation.

■ Operation will start even if you press the **F1** ( **F2** ) switch while the unit is stopped.

■ Energy-saving operation is only allowed when Heating, Cooling or Auto is selected for the operation mode.

Message “In operation for energy-saving.” is displayed on the screen during the energy-saving operation. Set temp is fixed at “28.0°C” in the cooling operation or “22.0°C” in the heating operation. Set temp shows “- °C” in the automatic operation mode.

■ Set temp cannot be changed during the energy-saving operation. If it is attempted, a message “Invalid request” is displayed on the screen.

**2** Energy-saving operation is terminated when you perform the following.

- When you terminate through a **Run/Stop** operation
- When you change the operation mode
- When you terminate the energy-saving operation with the **F1** ( **F2** ) switch

# 3. Quick reference of menu items

## Quick reference of menu items

It is necessary to input the Administrator password for menu items showing.

Setting and display items		Details	
Useful functions	Individual flap control	Set the moving range (upper and lower limit positions) of the flap at each blow outlet of IU. Set also the left limit position-rights limit position if FDK is used.	page 31
	Anti draft setting	If the panel with anti draft is used, set enable/disable of the each operation mode and anti draft operation of each blow outlet.	page 35
	Timer	Set ON timer by hour	page 44
		Set OFF timer by hour	page 46
		Set ON timer by clock	page 47
		Set OFF timer by clock	page 49
	Favorite setting Administrator password	Set each operation mode and setting temperature, fan speed, flap direction for Favorite setting 1 or Favorite setting 2.	page 58
	Weekly timer	On timer or Off timer on weekly basis can be set. ■ 8-operation patterns per day can be set at the maximum. ■ The time can be set at 5-minute intervals. ■ Holiday setting (including temporary day off) is available. *Clock setting is necessary to set the time.	page 50
	Home leave mode Administrator password	When the unit is not used for a long period of time, the room temperature is maintained at a moderate level, avoiding extremely hot or cool temperatures. ■ Cooling or heating is operated according to the outdoor temperature and the set temp. ■ Set temp and fan speed can be set.	page 54
	External ventilation	The ventilation is turned on or off if ventilation equipment is attached.	page 37
Energy-saving setting Administrator password	Select the language	Set the language to be displayed on the R/C.	page 73
	Silent mode control	The period of time to operate the unit by prioritizing the quietness can be set. ■ Start and end can be set for the silent mode.	page 72
	Sleep timer	Set the time period from start to stop of operation. ■ The selectable range of setting time is from 30 to 240 minutes (at 10-minute intervals). ■ When the setting is "Enable", this timer will activate whenever any operation starts.	page 25
	Peak-cut timer	Set the times to start and stop the capacity limiting operation and the peak-cut %. ■ 4 operation patterns per day can be set at the maximum. ■ The setting time can be changed at 5-minute intervals. ■ The selectable range of peak-cut % is from 0.40 to 80% (at 20% intervals). ■ Holiday setting (including temporary day off) is available. *Clock setting is necessary.	page 26
	Automatic temp set back	It returns to the set temperature when the set time is counted up. ■ The selection range of the set time is from 20 to 120 minutes (at 10-minute intervals).	page 29
	Motion sensor control	If the motion detector is used, set enable/disable of Power Control and autosave.	page 30

Setting and display items		Details		
Filter	Filter sign reset		Reset the filter sign. Set next cleaning date.	page 74
User setting	Initial settings	Clock setting	Set and correct the current date and time. ■ When the power supply is interrupted for 80 hours or less, the clock continues to operate with the built-in backup batteries. If it is interrupted for more than 80 hours, it is necessary to renew the setting.	page 38
		Date & time display	Set whether the date and time are displayed or not, and select 12H or 24H and AM or PM position.	page 39
		Summer time	Current time is advanced or delayed by 1 hour.	page 40
		Contrast	Contrast of LCD can be adjusted.	page 40
		Backlight	Select whether the backlight is used or not, and set the lighting time.	page 41
		Controller sound	Select whether the controller sound is actuated at the touch panel operation or not.	page 41
		Operation lamp luminance	Adjust operation lamp luminance.	page 42
	Administrator settings <div>Administrator password</div>	Permission/Prohibition setting	■ Set the permission/prohibition for each of following operations: [Run/Stop] [Change set temp] [Operation mode] [Change flap direction] [Change the fan speed] [High power operation] [Energy-saving operation] [Timer] ■ Set the administrator password request during operation. [Individual flap control] [Weekly timer] [Select the language] [Filter sign reset]	page 60
		Outdoor unit silent mode timer	The period of time to operate the unit by prioritizing the quietness can be set. ■ Starting and stopping times can be set for the silent mode operation. ■ The time can be set at 5-minute intervals.	page 61
		Setting temp range	Restrict the setting range of temperature. ■ Temperature range can be restricted depending on operation modes.	page 62
		Temp increment setting	Set the interval for setting temperature (0.5°C/1.0°C).	page 64
		Set temp display	Set temperature display method can be selected.	page 64
		R/C display setting	Register the names of remote control, indoor unit and zone name. Set Yes or No for the need of indoor temperature display. Set Yes or No for the need for the display of error code, heating standby, defrosting operation on and automatic cooling/heating.	page 65
		Change administrator password	Change the administrator password.	page 70
		F1/F2 function setting	Set the functions of F1 and F2 switch. Available functions: [High power operation] [Energy-saving operation] [Silent mode cont.] [Home leave mode] [Favorite set 1] [Favorite set 2] [Filter sign reset] [Anti draft ON/OFF]	page 71
Contact company & Error display		Address of the service contact is displayed.	page 76	

It is necessary to input the administrator password for menu items indicated with Administrator password

## Restrictions on the sub R/C

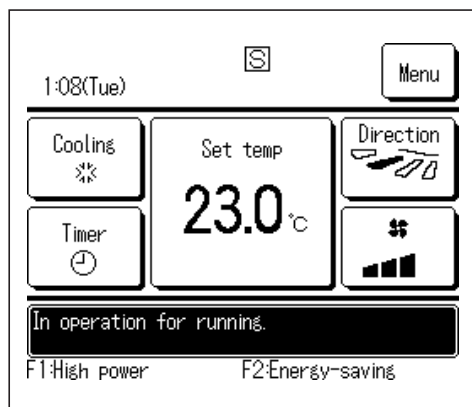

When one IU is controlled with 2 R/Cs, the following settings cannot be made on the sub R/C. It is necessary to use the main R/C.

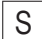
In case of the sub R/C, the icon  is displayed on the R/C screen.

○: operable ✕: not operable

R/C operations		Main	Sub
Run/Stop, Change set temp, Change flap direction, Auto swing, Change fan speed operations		○	○
High power operation, Energy-saving operation		○	○
Silent mode control		○	✕
Useful functions	Individual flap control	○	✕
	Anti draft setting	○	✕
	Timer	○	○
	Favorite setting	○	○
	Weekly timer	○	✕
	Home leave mode	○	✕
	External ventilation	○	○
	Select the language	○	○
Energy-saving setting		○	✕
Filter	Filter sign reset	○	○
User setting	Initial settings		○
	Administrator settings	Permission/Prohibition setting	○
		Outdoor unit silent mode timer	○
		Setting temp range	○
		Temp increment setting	○
		Set temp display	○
		R/C display setting	○
		Change administrator password	○
	F1/F2 function setting		○



## Operations on menu screens

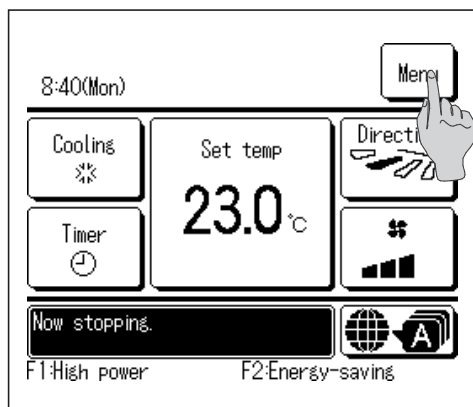

- 1 Tap the **Menu** button on the TOP screen.

Main menu screen is displayed.

When a desired menu item is tapped, setting screen for each item is displayed.

When there are two or more pages, the **Next** button is displayed at the leading page and the **Previous** button is displayed at the last page. The **Next** and **Previous** buttons are displayed on pages in between.

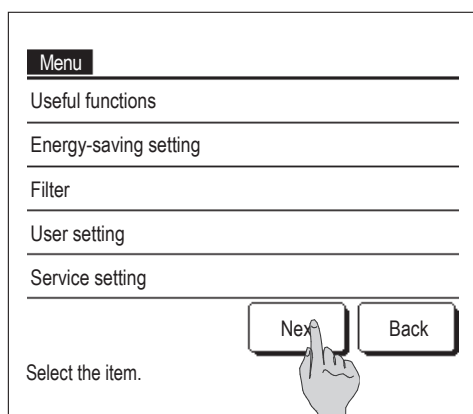

- 2 When the **Next** button is tapped, next main menu screen is displayed.

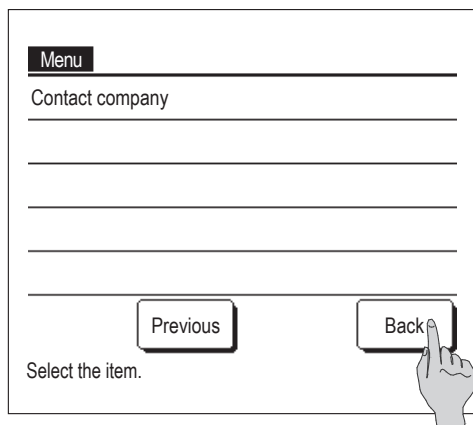

- 3 When the **Back** button is tapped, the display returns to the TOP screen.

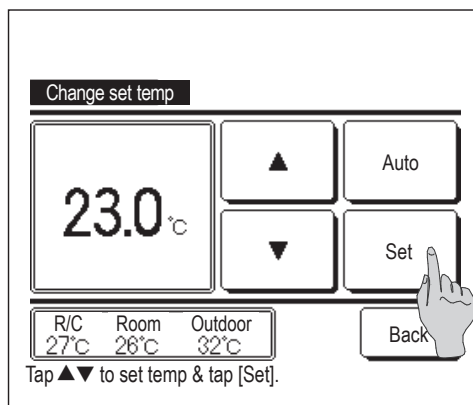

- 4 When the **Set** button is displayed on the setting screen for each item, tapping this button confirms the setting.

■ If you tap **Back** without tapping the **Set** button, the settings made will not be applied, and the display returns to the original screen.

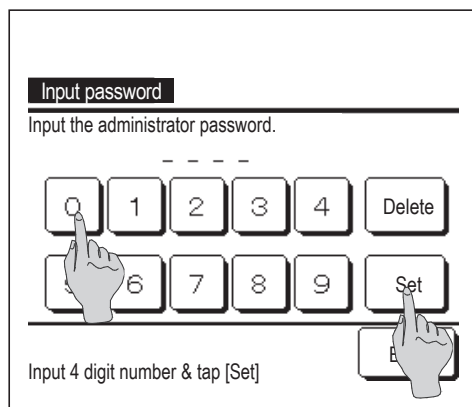

- 5** When an item is referenced to **Administrator password** in this manual, the Input password screen is displayed after selecting the menu.

Enter the administrator password (4-digit number) and tap the **Set** button.

When the password is unknown or wrong, the setting cannot be changed.

#### Advice

- The administrator password is provided so that these operations and settings are restricted to administrators/managers only (such as the owner of the building).
  - For the administrator password at the factory setting, refer to the Installation Manual.
- When your administrator password is forgotten, initialize the password by referring to the Installation Manual.

## Cautions for each setting screen

- When returning to the screen mentioned below from each setting screen, operate the following buttons or switches.
  - Return to Main screen ... **Menu** button
  - Return to the last previous screen ... **Back** button
  - Return to TOP screen ... **Run/Stop** switch
- When the **Back** button is tapped without tapping the **Set** button on the way of setting, contents of the setting are invalidated, and the display returns to the last previous screen. If the **Run/Stop** switch is pushed on the way of setting, contents of the setting are invalidated, the setting mode is terminated and the display returns to the TOP screen.
- If no button is operated for approx. 5 minutes on the way of setting each item, the display returns to the TOP screen automatically. Contents of the setting on the way become invalid.
- Message "Invalid request" may be displayed when a button is pushed. This is not a fault but it is because the button is set to the Prohibition.  
(page 60)
- It is necessary to stop the air conditioner by pushing the **Run/Stop** switch before starting the following settings. If the Set button is tapped on the menu screen while the air conditioner is operating, the message "Invalid request." is displayed.
 

■ Individual flap control	■ Anti draft setting	■ Select the language
■ Energy-saving setting	■ Administrator settings	

## 4. Settings and operations

### Energy-saving setting [Administrator password]

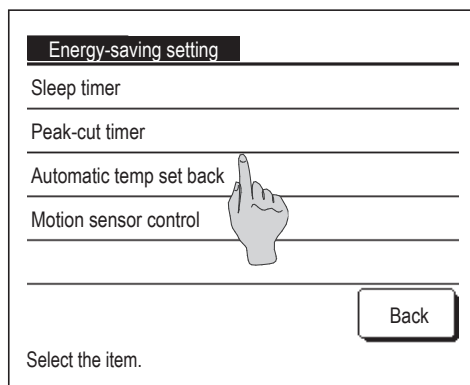

- 1 Tap the **Menu** button on the TOP screen and select **Energy-saving setting**. The Energy-saving setting menu screen is displayed.
- 2 When the Energy-saving setting screen is displayed, select a desired item.

- Sleep timer ..... page 25
- Peak-cut timer ..... page 26
- Automatic temp set back ..... page 29
- Motion sensor control ..... page 30

### ■ Sleep timer

Stops operation when the amount of time set has elapsed since the start of each operation.

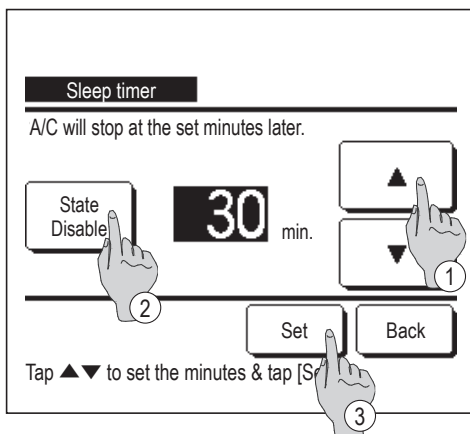

- 1 Tap the **Menu** button on the TOP screen and select **Energy-saving setting** ⇒ **Sleep timer**. The Sleep timer screen is displayed.
- 2 Select a desired time with ① buttons. Setting range: 30 to 240 minutes, at 10-min intervals.
- 3 Tap the ② **State** button to switch between “State Enable” and “State Disable”.
  - “Enable”: operation stops at the set time every time.
  - “Disable”: the sleep timer does not operate.

Unless the Sleep timer is used, set at the “State Disable”.

- 4 After the setting, tap the ③ **Set** button. The display returns to the Energy-saving setting menu screen.

## ■ Peak-cut timer

Set the times to start and stop the capacity (upper limit) limiting operation and the peak-cut %.

### Advice

- When the peak-cut timer is used, be sure to make the Clock setting in advance (☞ page 38).
- The peak-cut timer control may not be performed depending on combination of IU and OU.

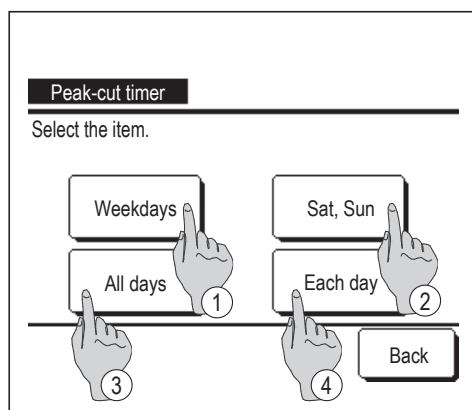

- 1 Tap the **Menu** button on the TOP screen and select **Energy-saving setting** ⇒ **Peak-cut timer**.

When the setting range selection screen for the peak-cut timer is displayed, select the day of the week to be set.

- ① Weekdays : Monday - Friday
- ② Sat. Sun : Saturday, Sunday
- ③ All days : Monday - Sunday
- ④ Each day : Moves to the day of the week setting screen. (☞ 2)

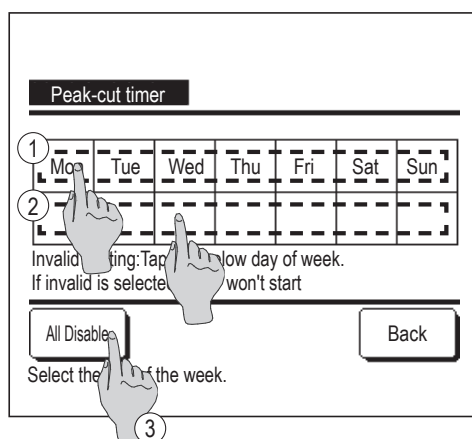

- 2 If a desired day of the week ① is tapped on the display, contents of current setting for the day are displayed. (☞ 5)

- 3 For the holiday setting, tap the block ② under a day to switch between "☞" (the holiday setting) and "(Blank)" (reset).

Timer does not operate on the day set as holiday.

Two or more holidays can be set.

■ To enable the timer on the day set as holiday, it is necessary to reset the holiday setting.

- 4 When tapping ③ "All Disable" button, the timer does not operate on all days of the week.

When the timer is used, be sure not to set "All Disable".

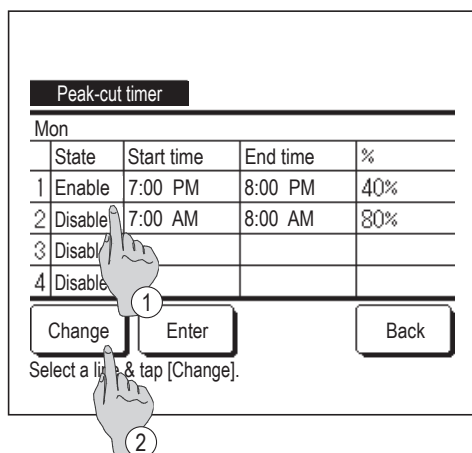

## 5 Screen to check contents of current setting is displayed.

When the contents are changed or new setting is added, select a ① setting line No. and tap the ② **Change** button.

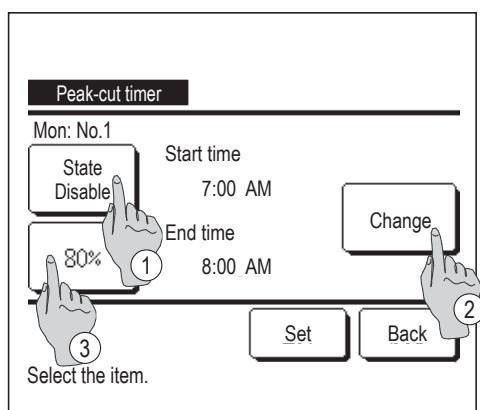

## 6 Detail setting screen for the timer setting contents is displayed.

- ① Tap the **State** button to switch between “State Enable” and “State Disable”.
- ② If the **Change** button is tapped, the start time and the end time can be set. (➡7)
- ③ If the **Peak-cut** button is tapped, the peak-cut % can be set. (➡9)

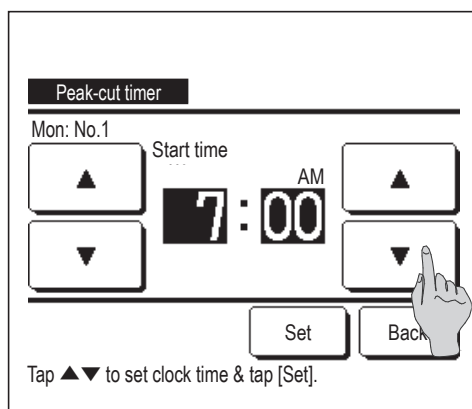

## 7 Set the Start time.

Set the hour and minute with the ▲ ▼ buttons.

Setting time can be set at 5-min intervals.

Tap the **Set** button after the setting. (➡8)

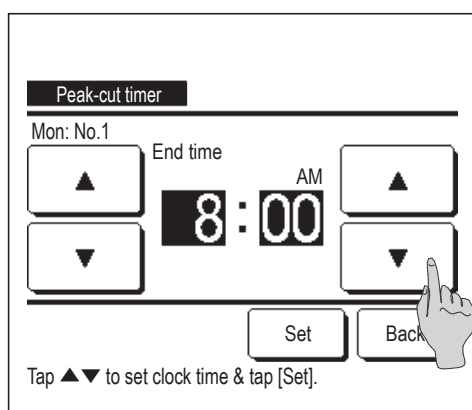

## 8 Set the End time.

Set the hour and minute with the ▲ ▼ buttons.

End time can be set from 5 minutes after the Start time up to 24:00 at 5-min intervals

Tap the **Set** button after the setting.

(➡10)

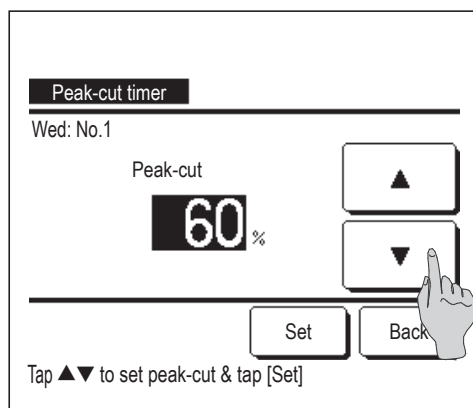

## 9 Set the peak-cut %.

Set the peak-cut % with the buttons.

The peak-cut % can be set at 0%, 40%, 60% or 80%.

**The lower the peak-cut % is, the higher the effect of energy-saving becomes.**

Tap the button after the setting.

( 10)

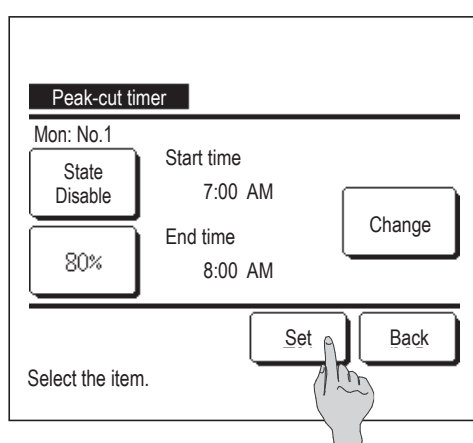

**10** The setting content check screen ( 6) is displayed. If the button is tapped, the contents are confirmed and a day of the week setting content check screen ( 5) is displayed.

**11** If the settings are corrected or added further within the same day, repeat the setting. ( 5)

■ When contents of the setting are duplicated, the priority is given to the set contents of smaller peak-cut %.

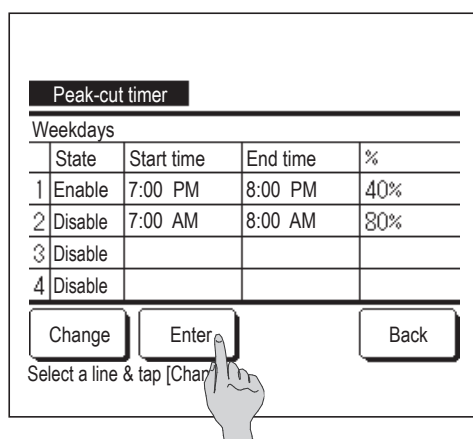

**12** Display a day of the week setting content check screen. To save the setting, tap the button.

- a) In case of group setting: (1-① Weekdays, 1-② Sat, Sun, 1-③ All days) Move to the group setting check screen. ( 13)
- b) In case of individual setting: (1-④ Each day) Save the setting and move to a day of the week selection screen ( 2)

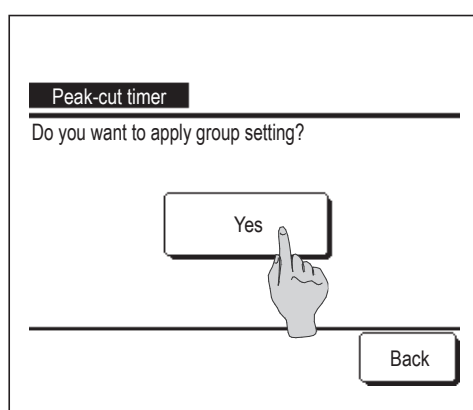

**13** Display the group setting acknowledge screen.

Tap the button to save the setting.

The display changes to a day of the week setting check screen after the saving. ( 2)

**14** When making the setting after changing a day of the week, repeat the setting from the step 2.

## ■ Automatic temp set back

It returns to the set temperature when the set time is counted up.

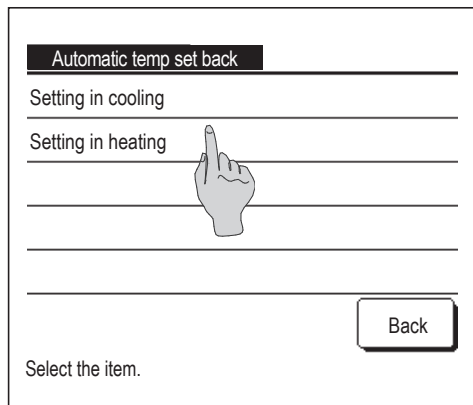

- 1 Tap the **Menu** button on the TOP screen and select **Energy-saving setting** ⇒ **Automatic temp set back**. The Automatic temp set back screen is displayed.

Tap **Setting in cooling** when setting for the cooling operation or **Setting in heating** when setting for the heating operation.

The Setting in cooling operation includes the cooling, dry and auto.

The Setting in heating is for the heating operation only.

Setting time range: 20 - 120 min, at 10-min intervals

Set temp range: It can be set within the preset temp range set according to the set temp range menu. (page 62)

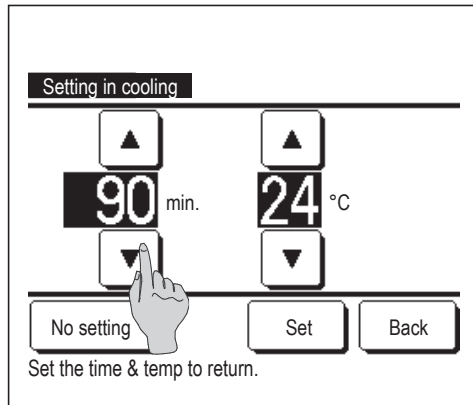

- 2 Set desired time and temperature with the **▲** **▼** buttons.

When the **Set** button is tapped, contents of setting are confirmed, and the display returns to the last previous screen.

When the **No setting** button is tapped, "-- min. --°C" is displayed, and the "Automatic temp set back" is not performed.

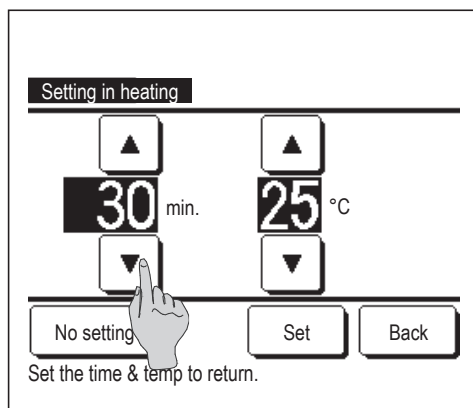

- 3 The same setting method as the Setting in the cooling operation can be applied to the Setting in heating.

## ■ Motion sensor control (for IUs with motion sensors)

Presence of humans and the amount of motion are detected by a motion sensor to perform various controls.

■ When the R/C is set as the sub R/C, the motion sensor control cannot be set.

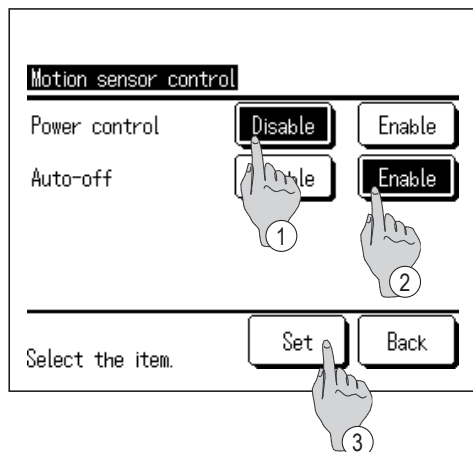

- 1 Tap the **Menu** button on the TOP screen and select **Energy-saving setting** ⇒ **Motion sensor control**.

The Motion sensor control screen and contents of the current settings are displayed.

- ① Enable/disable power control.
- ② Enable/disable auto-off.
- ③ After you set each item, tap the **Set** button.

The display returns to the Energy-saving setting menu screen.

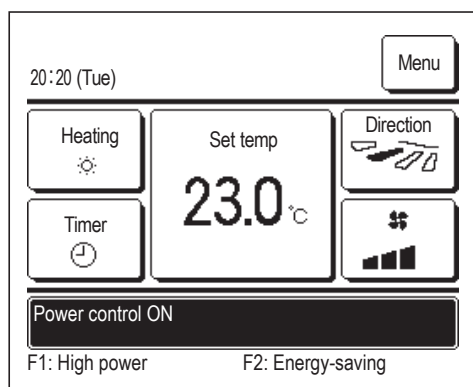

- When power control is enabled

The amount of human motion is detected by a motion sensor to adjust the Set temp.

During power control, "Power control ON" will be displayed on the message display.

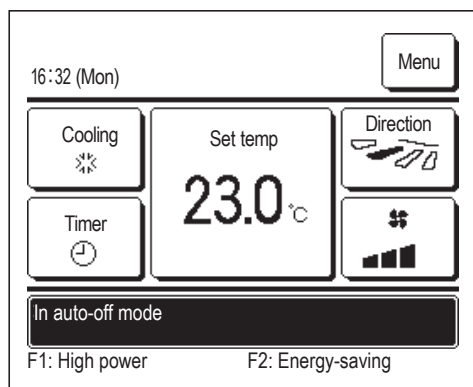

- When auto-off is enabled

The unit will enter the "Operation wait" state when an hour has elapsed since the last time a human presence was detected and will be in "Complete stop" state after another 12 hours.

"Operation wait"...The unit stops but will resume operation when human presence is detected.

When the unit is in "Complete stop", "In auto-off mode" will be displayed on the message display.

"Complete stop"...When auto-off is enabled, the unit stops.

The unit will not resume operation even when human presence is detected.

The message "In auto-off mode" will disappear from the message display, and the operation lamp will turn off.



## Individual flap control

Motion range (upper, lower, left, or right limit positions) of the flap at each blow outlet can be set to a desired range.

■ When the R/C is set as the sub R/C, the individual flap control cannot be set.

- 1 Tap the **Menu** button on the TOP screen and select **Useful functions** ⇒ **Individual flap control**, or tap the **Change flap direction** button on the TOP screen and select **Ind. flap control**, and then enter the administrator password.

When one IU is connected to the R/C: ➡ 3

When two or more IUs are connected to the R/C: ➡ 2

### Advice

- Individual flap control should be set when the unit is stopped.
- When you perform Individual flap control while the unit is in operation, the acknowledge screen for unit stop is displayed.

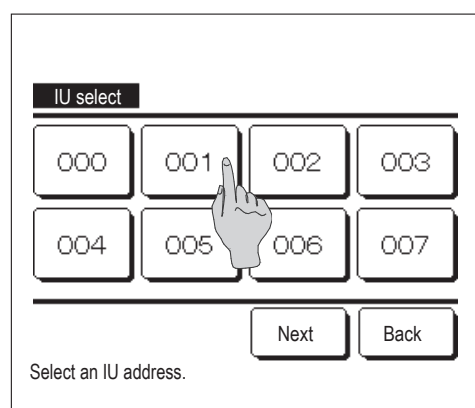

- 2 When two or more IUs are connected to the R/C, a list of IUs is displayed. Tap the IU to be set.

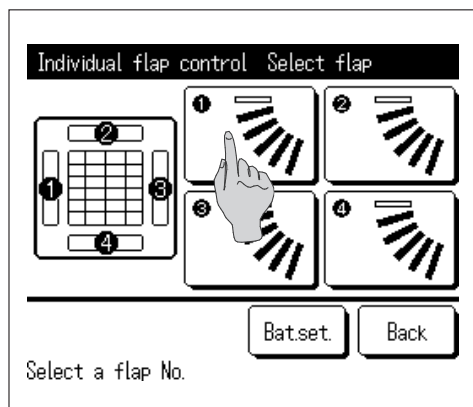

### 3 Select the number of the flap of which the motion range is changed. (P. 4)

■ When there are two or more flaps at the blow outlet, such as the FDT type, the flap at blow outlet No. ① will keep moving while the blow outlet selection screen is displayed. The figure displayed on the screen shows the installed unit viewed from the floor side. Select the flap based on this figure. When you have selected the blow outlet, the flap with the number you selected will move.

#### Advice

• This operation is not performed when individual flap control is set during operation.

■ You can set all flaps at once by tapping the **Bat.set.** button (except for FDKs with a left/right flap).

■ When there is only one flap at the blow outlet, such as the ceiling suspended type only the flap that can be set will be displayed.

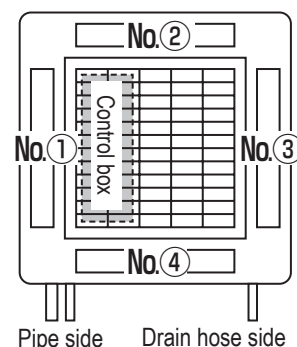

**Louver No.  
[For FDT]**

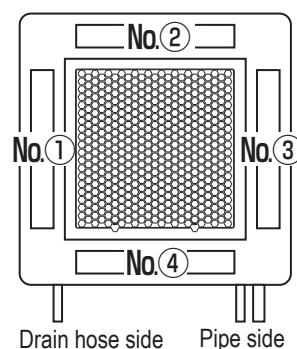

**Louver No.  
[For FDTc]**

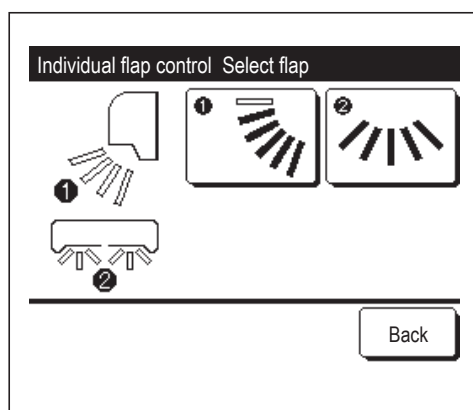

For an FDK with a left/right flap, select the upper/lower flap or left/right flap.

When you select the upper/lower flap (①): P. 4

When you select the left/right flap (②): P. 8

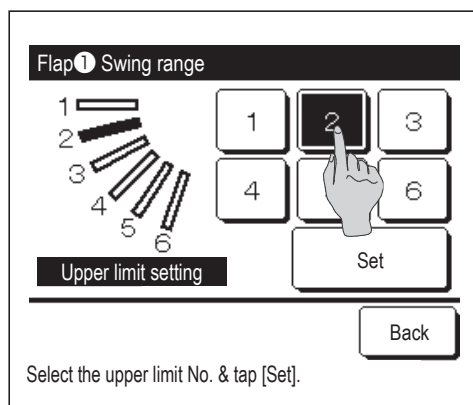

### 4 Select one of the upper limit positions from 1 to 6 for the flap motion range.

After you select the range, tap the **Set** button.

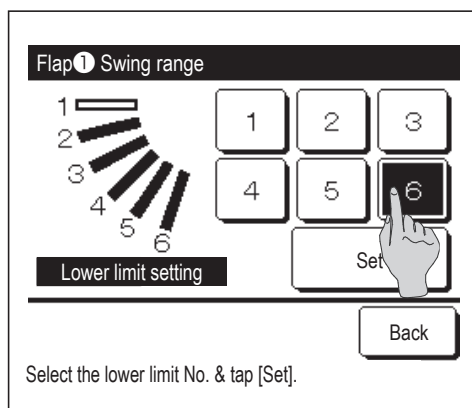

- 5** Select one of the lower limit positions from **1** to **6** for the flap motion range.

The range of motion between the upper and lower limit positions will be displayed in black.

After you select the range, tap the **Set** button.

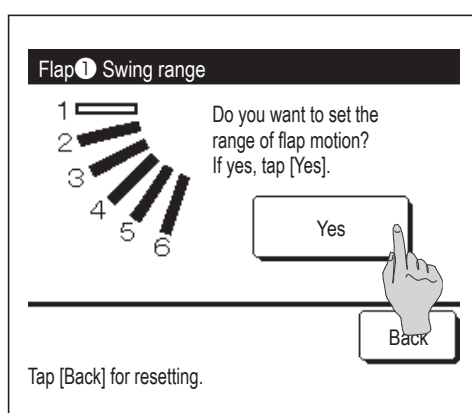

- 6** Acknowledge screen for the flap motion range is displayed.

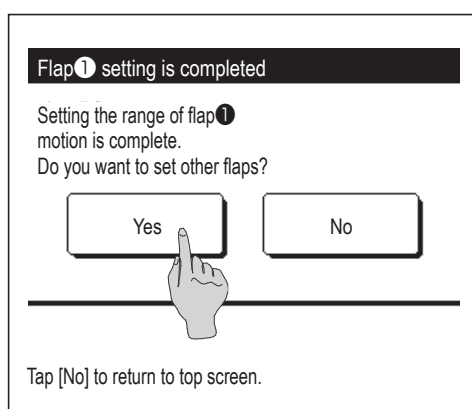

- 7** Acknowledge screen for the completion of setting is displayed.

To change other flap motion ranges, tap the **Yes** button (➡ **3**).

To terminate the setting, tap the **No** button. The display returns to the TOP screen.

[When left/right flap is selected for an FDK with a left/right flap]

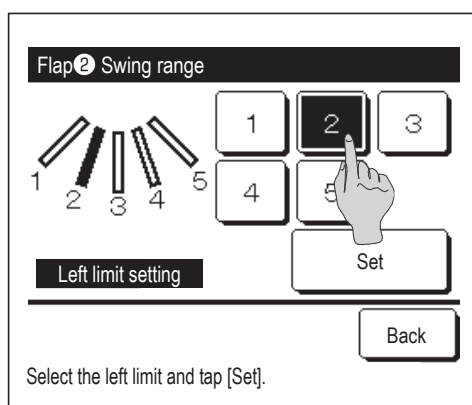

- 8** Select one of the left limit positions from **1** to **5** for the flap motion range.

After you select the range, tap the **Set** button.

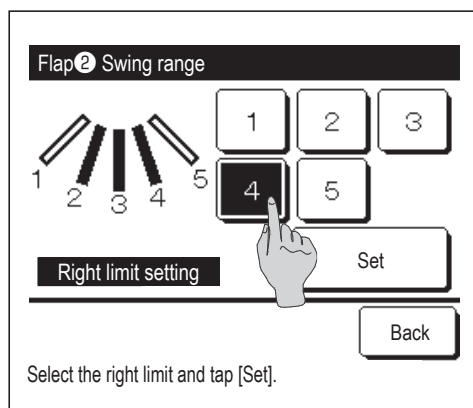

- 9** Select one of the right limit positions from  to  for the flap motion range.

The range of motion between the left and right limit positions will be displayed in black.

After you select the range, tap the  button.

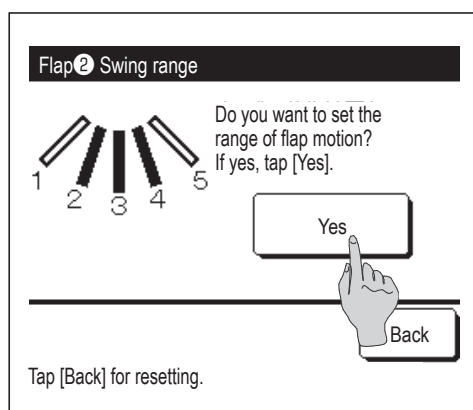

- 10** Acknowledge screen for the flap motion range is displayed.

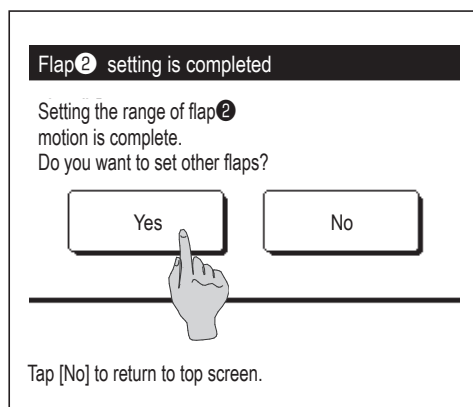

- 11** Acknowledge screen for the completion of setting is displayed.

To change other flap motion ranges, tap the  button. (➡3)

To terminate the setting, tap the  button. The display returns to the TOP screen.

### Advice

When the unit is installed within 50 cm from a wall, it is recommended that you change the range of the left/right flap motion as follows:

- When installed at the right end of the wall  
Left/right flap motion range  to
- When installed at the left end of the wall  
Left/right flap motion range  to

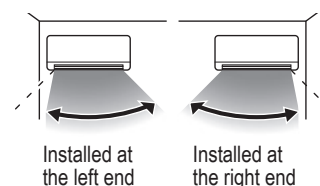

## Anti draft setting (for using panel with anti draft)

You can set ON/OFF (operation/stop) of the anti draft function and can also enable/disable the motion of panel with anti draft for each blow outlet for each operation mode.

■ When the R/C is set as the sub R/C, the anti draft setting cannot be set.

- 1 Tap the **Menu** button on the TOP screen and select **Useful functions** ⇒ **Anti draft setting**.

The Anti draft setting menu is displayed.

■ Depending on how the Permission/Prohibition setting (☞ page 60) is set, the administrator password input screen may be displayed.

- 2 Tap a desired item.

- ① Details..... You can set Enable or Disable for anti draft motion performed at each blow outlet in each operation mode. (☞ page 35)
- ② ON/OFF setting.... You can set ON/OFF (operation/stop) of anti draft function for the enabled blow outlet set in ① Details. (☞ page 37)

### ■ Details

- 1 When two or more IUs are connected to the R/C, a list of IUs is displayed. Tap the IU to be set.

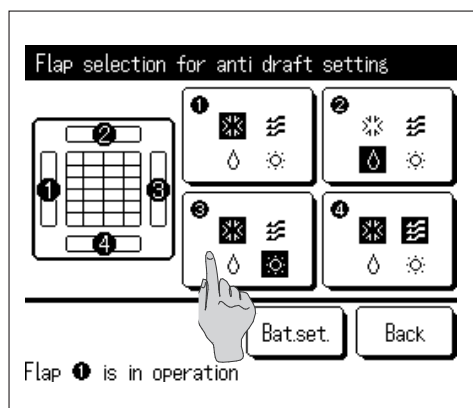

## 2 Select the blow outlet number to set anti draft.

■ The flap at blow outlet No. ① will keep moving while the blow outlet selection screen is displayed. Select the flap based on this figure. When you have selected the blow outlet, the flap with the number you selected will move. The figure displayed on the screen shows the installed unit viewed from the floor side.

■ You can set all blow outlets at once by tapping the **Bat.set.** button.

An icon that indicates the operation mode (page 10) is shown on each blow outlet button.

When the anti draft setting is enabled, the icon color will be reversed (for example, in the left figure, blow outlets which have the anti draft setting enabled during cooling are numbers ①, ③, and ④).

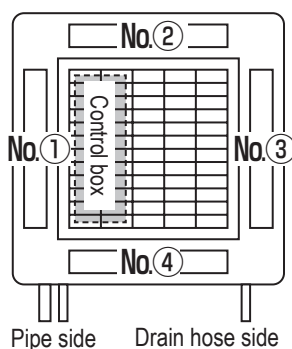

**Blow outlet No.  
[For FDT]**

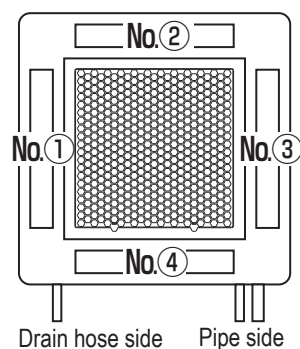

**Louver No.  
[For FDTC]**

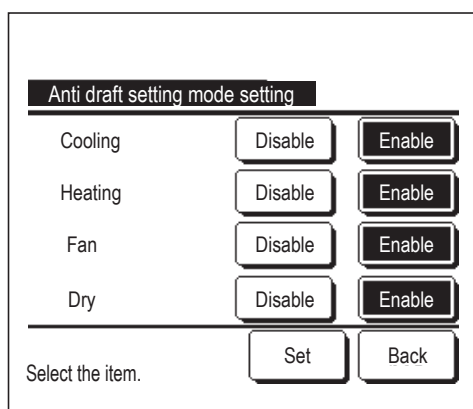

## 3 Select enable/disable for each operation mode.

After you make the selection, tap the **Set** button.

The display returns to the blow outlet selection screen.

## ■ ON/OFF setting

Anti draft ON/OFF setting

000 ON	001 OFF	002 ON	003 OFF
004 ON	005 OFF	006 ON	007 OFF
008 ON	009 OFF	010 ON	011 OFF
012 ON	013 OFF	014 ON	015 OFF

- 1 The indoor unit No. and the ON/OFF state of each anti draft function are displayed to allow ON/OFF setting of the anti draft. Anti draft is turned OFF by tapping ON and turned ON by tapping OFF.

When two or more indoor units equipped with anti draft function are connected to the R/C, the two or more indoor units are displayed.

All of the connected indoor units that are equipped with anti draft function are turned OFF by pressing the  button.

All of the connected indoor units that are equipped with anti draft function are turned ON by pressing the  button.

## Ventilation operation (when ventilation device is installed)

The ventilation is turned on or off if the ventilation device is installed.

- 1 Tap the  button on the TOP screen and select  ⇒ .

■ The ventilation operation is enabled in case that the External ventilation is set "Independent" (refer to the installation manual for details).

■ In case that the External ventilation is set "Disable" or "Interlocking" the ventilation operation is disable.

External ventilation

Select Venti. ON/OFF.

- 2 The External ventilation screen is displayed.

If the  button is tapped, the ventilation operation starts.

To stop the ventilation operation, tap the  button.

■ In case that the Ventilation is set "Interlocking", the ventilation operates interlocked with Run/Stop operation of air conditioner (refer to Installation Manual).

## Initial settings

- 1 Tap the **Menu** button on the TOP screen and select **User setting** ⇒ **Initial settings**.

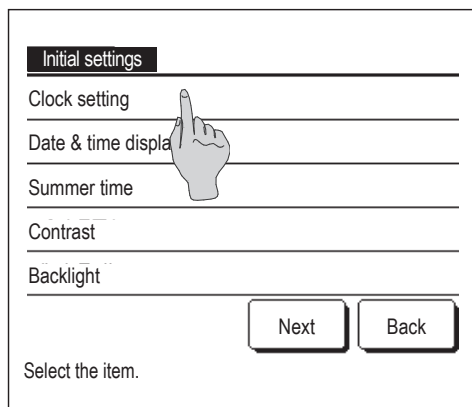

- 2 When the “Initial settings” menu screen is displayed, tap a desired item.

- Clock setting ..... page 38
- Date & time display ..... page 39
- Summer time ..... page 40
- Contrast ..... page 40
- Backlight ..... page 41
- Controller sound ..... page 41
- Operation lamp luminance ..... page 42

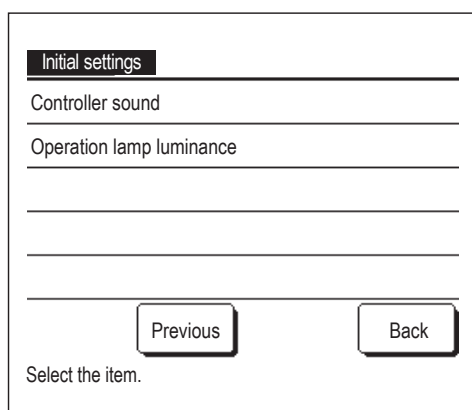

## ■ Clock setting

You can set and correct the current date and time.

- 1 Tap the **Menu** button on the TOP screen and select **User setting** ⇒ **Initial settings** ⇒ **Clock setting**.

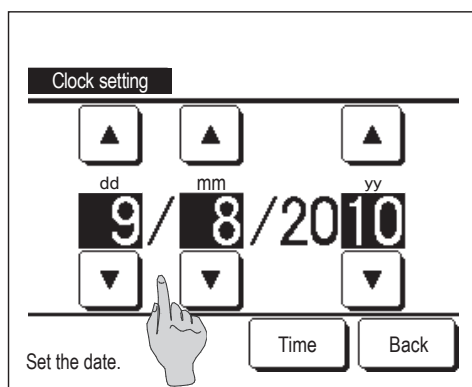

- 2 The “Clock setting” screen is displayed.

Set the “dd/mm/yy” with the buttons.

Tap the **Time** button after the setting.

■ The “clock setting” is necessary for the following settings.

- Peak-cut timer
- Set ON timer by clock, Set OFF timer by clock
- Weekly timer
- Outdoor unit silent mode timer
- Filter sign reset, Setting next cleaning date



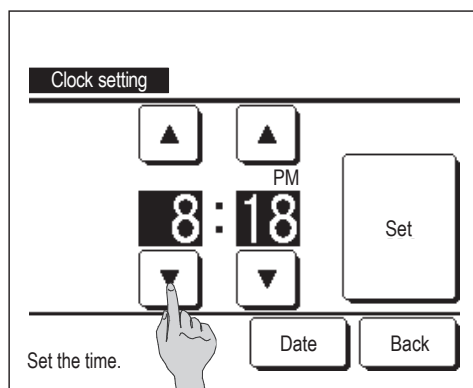

- 3** Set the “hour : minute” with the   buttons on the clock setting screen.

Tap the  button after the setting.

To change “dd/mm/yy” tap the  button.

## ■ Date & time display

You can set and correct the date & time display.

- 1** Tap the  button on the TOP screen and select  ⇒  ⇒ .

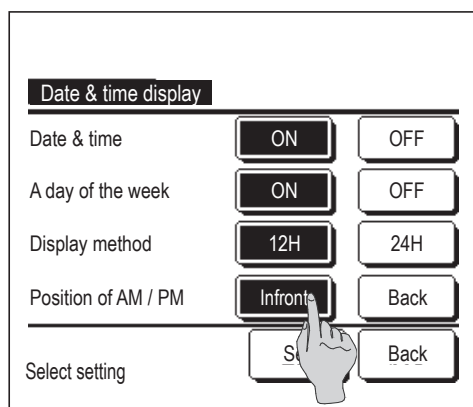

- 2** The Clock setting screen is displayed.

Tap  /  for the Date and time.

Tap  /  for A day of the week.

Tap Display method “12H or 24H”.

Hours ... If it is 3:50 PM, it displays “3:50PM”.

Hours ... If it is 3:50 PM, it displays “15:50”.

Set the position of AM/PM.

Set  ... “PM3:50” is displayed.

Set  ... “3:50PM” is displayed.

- 3** Tap the  button after the setting.

## ■ Summer time

You can adjust the current time by one hour.

- 1 Tap the **Menu** button on the TOP screen and select **User setting** ⇒ **Initial settings** ⇒ **Summer time**.

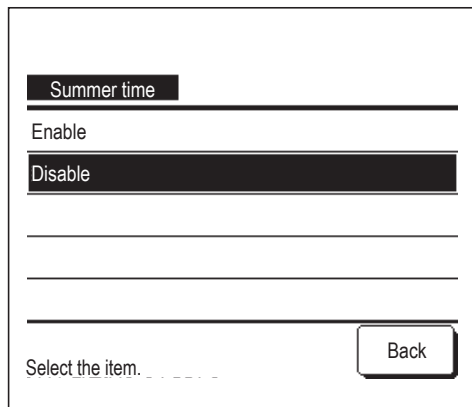

- 2 The Summer time setting screen is displayed.

Changing from **Disable** to **Enable** ... (Current time + 1 hr) is displayed.

Changing from **Enable** to **Disable** ... (Current time – 1 hr) is displayed.

## ■ Contrast

You can adjust the contrast of the LCD.

- 1 Tap the **Menu** button on the TOP screen and select **User setting** ⇒ **Initial settings** ⇒ **Contrast**.

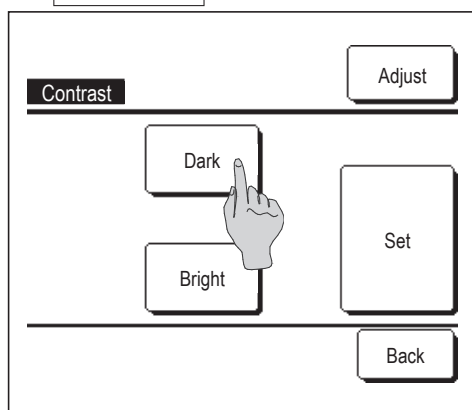

- 2 The Contrast Adjustment screen is displayed.

Tap the “Contrast” on the Initial settings menu screen. The contrast on the screen changes by tapping the **Dark** or **Bright** button to select a desired contrast.

- 3 Tap the **Set** button after the setting.

[When the contrast differs between the top and bottom of the screen]

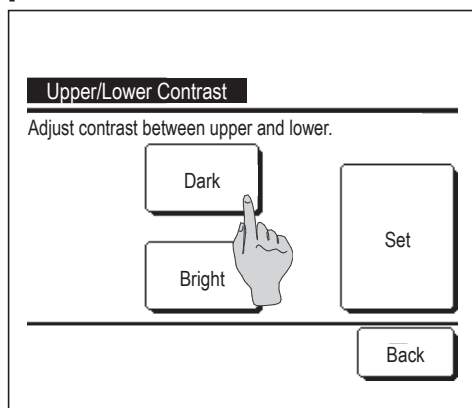

- 4 Tap the **Adjust** button to display the Upper/Lower Contrast screen.

- 5 The contrast of the lower half of the screen changes when you tap the **Dark** / **Bright** button. Adjust the contrast so that the upper and lower halves of the screen match.

- 6 After you make the settings, tap the **Set** button.

## ■ Backlight

You can turn ON/OFF the backlight and set the lighting period.

- 1 Tap the **Menu** button on the TOP screen and select **User setting** ⇒ **Initial settings** ⇒ **Backlight**.

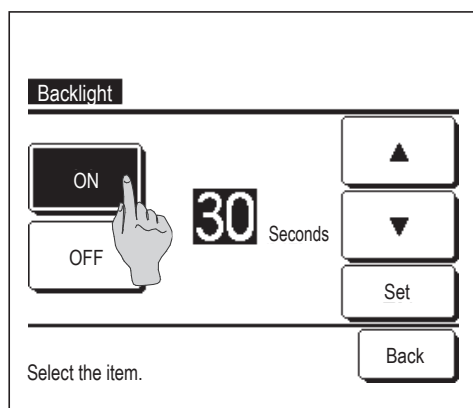

- 2 The Backlight setting screen is displayed.

Tap the ON or OFF buttons for the backlight lighting and the lighting Period (5 - 90 sec, at 5-sec intervals).

**ON** ... The “Backlight” lights when the LCD is tapped.

If no operation is made for the set time, it turns off automatically.

**OFF** ... The “backlight” does not light even if the LCD is tapped.

- 3 Tap the **Set** button after the setting.

## ■ Controller sound

You can set to have the controller sound ON/OFF when the touch panel is operated.

- 1 Tap the **Menu** button on the TOP screen and select **User setting** ⇒ **Initial settings** ⇒ **Controller sound**.

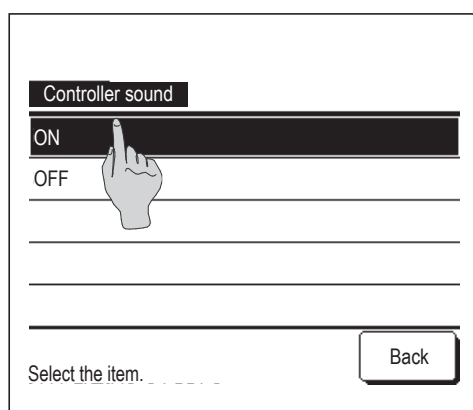

- 2 The Controller sound setting screen is displayed.

Tap ON or OFF for the controller sound.

**ON** ... When a button on the screen is tapped, a “beep” sounds.

**OFF** ... There is no beep.

## ■ Operation lamp luminance

You can adjust the operation lamp luminance.

- 1 Tap the **Menu** button on the TOP screen and select **User setting** ⇒ **Initial settings** ⇒ **Operation lamp luminance**.

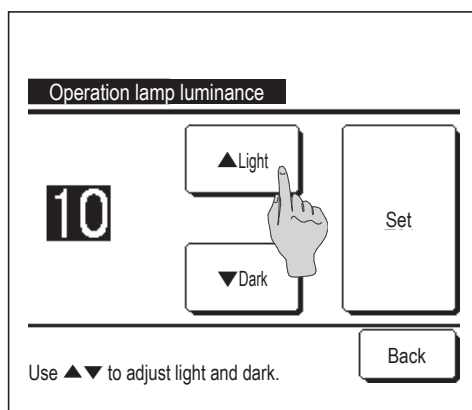

- 2 The Operation lamp luminance adjustment screen is displayed.

You can adjust the luminance of the operation lamp to a desired level by tapping the **▲ Light** / **▼ Dark** button.

- 3 After you make the settings, tap the **Set** button.

## Timer

### Advice

· The Clock setting (☞ page 38) must be made when the Set ON timer by clock or Set OFF timer by clock is used.

- 1 Tap the **Menu** button on the TOP screen and select **Useful functions** ⇒ **Timer**

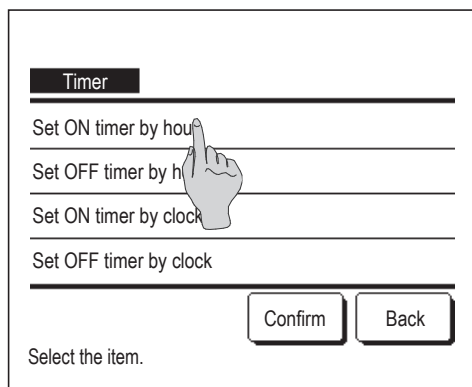

- 2 Tap a desired item on the Timer menu.

- Set ON timer by hour .....☞ page 44
- Set OFF timer by hour .....☞ page 46
- Set ON timer by clock .....☞ page 47
- Set OFF timer by clock .....☞ page 49
- Confirm .....☞ page 50

When the timer is set, the **Confirm** button is displayed.

The button is not displayed unless the timer is set.

## ■ Operation of each timer

### • Sleep timer (☞ page 25)

Stops the operation of the unit when the amount of time set has elapsed since the start of the operation. When the setting is enabled, this timer will activate whenever any operation starts.

### • Set ON timer by hour (☞ page 44)

When the set time elapses, the air conditioner starts.

Operating conditions at the start of operation can be set.

Operation takes place once at each setting.

### • Set OFF timer by hour (☞ page 46)

When the set time elapses, the air conditioner stops.

Operation takes place once at each setting.

### • Set ON timer by clock (☞ page 47)

The air conditioner starts at the set time.

Operating conditions at the start of operation can be set.

Only one day (Once) operation or operation Everyday can be set.

### • Set OFF timer by clock (☞ page 49)

The air conditioner stops at the set time.

Only one day (Once) operation or operation Everyday can be set

### • Weekly timer (☞ page 50)

On timer and Off timer on weekly basis can be set.

## ■ Setting of each timer can be combined. Allowable combination settings are as shown below.

### Allowable combination setting (○: Allowed, ×: Prohibited)

	Sleep	OFF: Hours	ON: Hours	OFF: Clock	ON: Clock	Weekly
Sleep		×	×	○	○	○
OFF: Hours	×		×	×	×	×
ON: Hours	×	×		×	×	×
OFF: Clock	○	×	×		○	×
ON: Clock	○	×	×	○		×
Weekly	○	×	×	×	×	

If a prohibited combination setting is made, a message "The combination can't be accepted" is displayed for 3 seconds.

## ■ Priority order of the timer settings (①→③) is as follows.

① Set OFF timer by hour/clock, weekly OFF timer

② Sleep timer

③ Set ON timer by hour/clock, weekly ON timer

## ■ On the TOP screen, the timer is displayed from the earliest one out of OFF time of the sleep timer, ON time and OFF time.

## ■ Set ON timer by hour

When the set time elapses, the air conditioner starts.

- 1 Tap the **Menu** button on the TOP screen and select **Useful functions** ⇒ **Timer** ⇒ **Set ON timer by hour**.

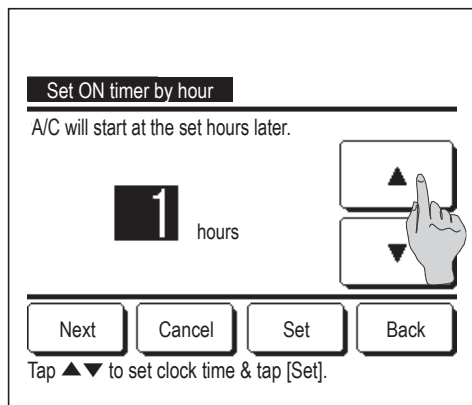

- 2 The Set ON timer by hour setting screen is displayed.

Select desired hours for the period to start operation by timer with the **▲** **▼** buttons.

Range of setting time: 1 to 12 hours (at 1-hr intervals)

- 3 When operating conditions at the start of operation are set, tap the **Next** button. (→ 4)

When operating conditions are not set, tap the **Set** button.

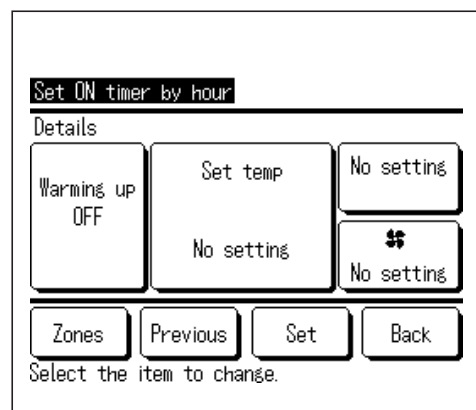

- 4 Set the following operating conditions.

① Warming up ON/OFF

(the Main R/C only)

② Operation mode ... → 5

③ Set temp ... → 6

④ Fan speed ... → 7

⑤ Zones ... → 9

■ Warming up setting can be made with the main R/C only.

■ Set the operation mode before setting the set temperature.

### Advice

### Warming up

- To warm up the room temperature closed to the set temperature at the set start time of the operation, the microcomputer estimates the start time of the operation based on the last warming up operation and starts the operation 5 to 60 minutes earlier.
- When the warming up is turned ON, set the timer at one hour earlier or more than the start operation by timer.  
If it is set in less than one hour, a message "Warming up cancelled" is displayed on the screen. (This is used as the Set ON timer by hour and clock.)

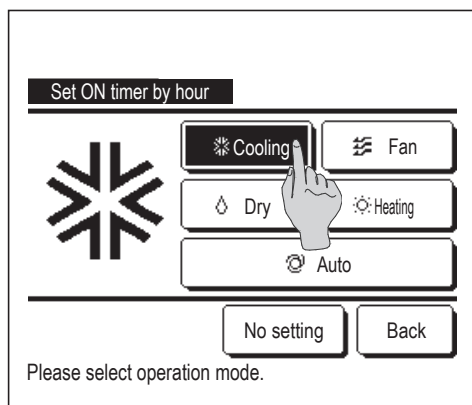

- 5 Tap a desired operation mode.

If the **No setting** button is tapped, it starts operation at the last action. (→ 4)

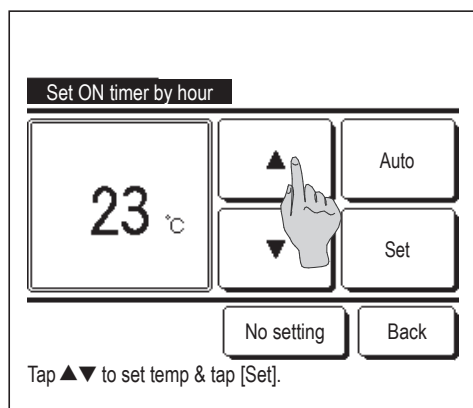

- 6** Select a desired temperature (at 1°C intervals) with the   buttons. Or tap the  button and select the auto temp setting.

Tap the  button after the adjustment. (→ 4)

When the  button is tapped, "--°C" is displayed, and it starts operation at the last setting temperature.

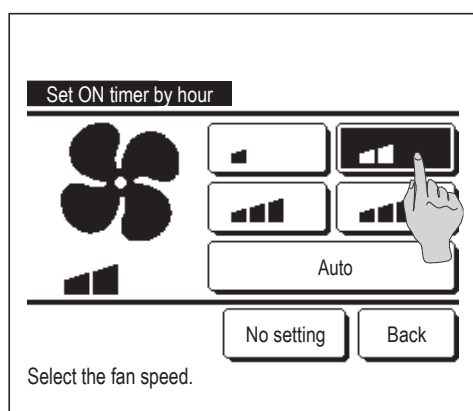

- 7** Tap a desired fan speed.

If the  button is tapped, it operates at the last action. (→ 4)

- 8** After setting the desired contents at the screen of the step 4 on the previous page, tap the  button.

Operation will start at set hours later.

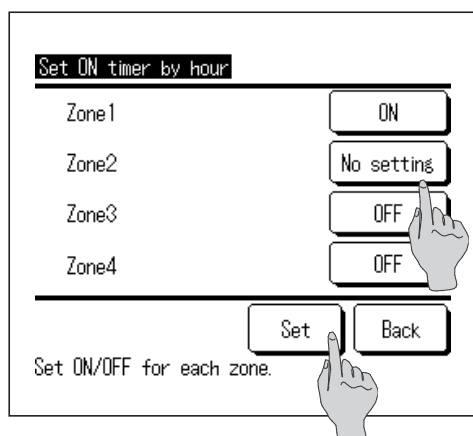

- 9** Tapping the  button makes it possible to perform zone operation settings at the time of timer working. Set  /  /  (No setting/OPEN/CLOSE) for each zone during timer operation.

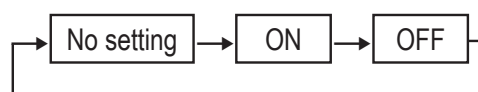

Setting  will operate in the previous zone state at the time of timer working.

After the setting, tap the  button.

The display returns to the previous screen.

## ■ Set OFF timer by hour

When the set time elapses, the air conditioner stops.

- 1 Tap the **Menu** button on the TOP screen and select **Useful functions** ⇒ **Timer** ⇒ **Set OFF timer by hour**.

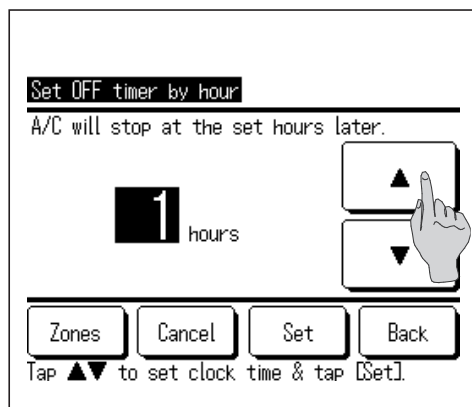

- 2 The Set OFF timer by hour setting screen is displayed.

Select desired hours to stop operation with the ▲ ▼ buttons.

Range of setting time: 1 to 12 hours (at 1-hr intervals)

- 3 The **Zones** button is displayed when performing zone settings. Tapping the **Zones** button makes it possible to perform zone operation settings at the time of timer working. (The **Zones** button is not displayed when not performing zone settings. Proceed to step 5.)

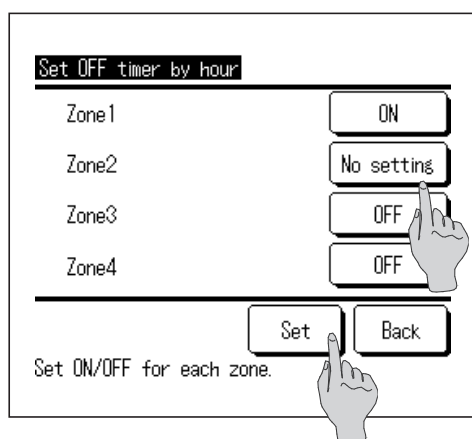

- 4 Tapping the **Zones** button will transition to the zone operation setting screen. Set **No setting** / **ON** / **OFF** (No setting/OPEN/CLOSE) for each zone during timer operation.

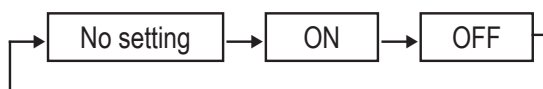

Setting **No setting** will operate in the previous zone state at the time of timer working.

After the setting, tap the **Set** button.

The display returns to the previous screen.

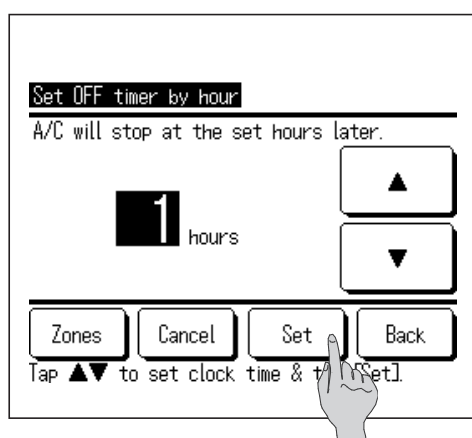

- 5 After the setting, tap the **Set** button. The display returns to the Timer menu screen.



## ■ Set ON timer by clock

Starts the operation of the unit at the set clock time.

- 1 Tap the **Menu** button on the TOP screen and select **Useful functions** ⇒ **Timer** ⇒ **Set ON timer by clock**.

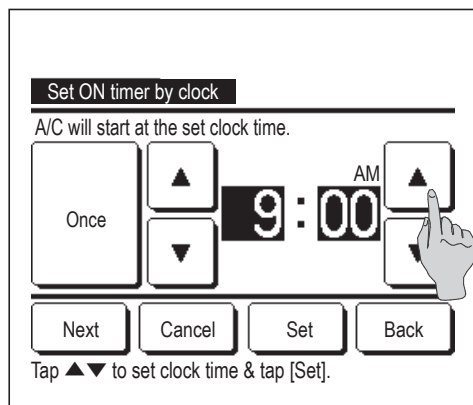

- 2 The Set OFF timer by hour setting screen is displayed.

Select a desired time to start operation (5-min intervals) with the **▲** **▼** buttons.

- 3 When operating conditions at the start of operation are set, tap the **Next** button to set operation conditions. (→ 4)

If operating conditions are not set, tap the **Set** button.

The Set ON timer by clock can be operated one day (Once) or everyday.

If it is operated everyday, tap the **Once** / **Everyday** button to change the display to "Everyday".

- 4 Set the following operating conditions.

- ① Warming up ON/OFF (the Main R/C only)
- ② Operation mode ... → 5
- ③ Set temp ... → 6
- ④ Fan speed ... → 7
- ⑤ Zones ... → 9

■ Warming up setting can be made with the main R/C only.

■ Set the operation mode before setting the set temperature.

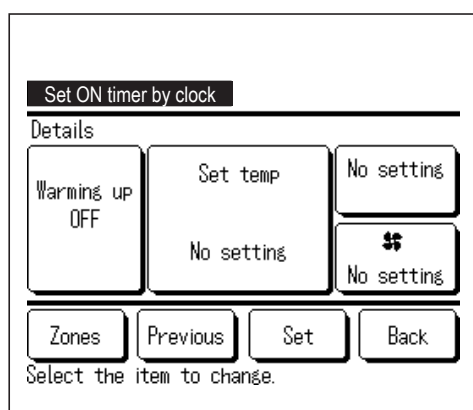

### Advice

### Warming up

- To warm up the room temperature closed to the set temperature at the set start time of the operation, the microcomputer estimates the start time of the operation based on the last warming up operation and starts the operation 5 to 60 minutes earlier.
- When the warming up is turned ON, set the timer at one hour earlier or more than the start operation by timer.  
If it is set in less than one hour, a message "Warming up cancelled" is displayed on the screen. (This is used as the Set ON timer by hour and clock.)

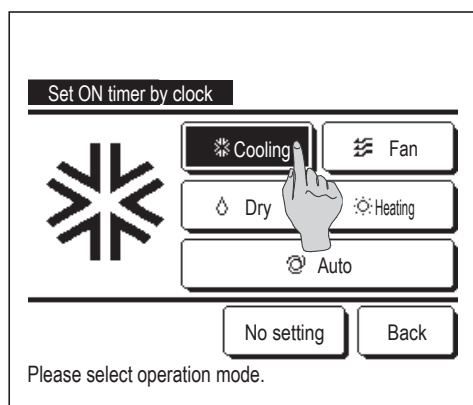

- 5 Tap a desired operation mode.

If the **No setting** button is tapped, it starts operation at the last action. (→ 4)

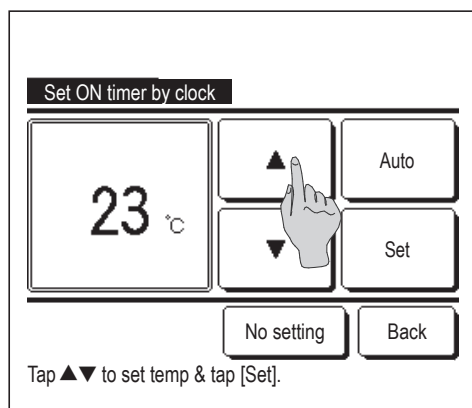

- 6** Select a desired temperature (at 1°C intervals) with the   buttons. Or tap the  button and select the auto temp setting.

Tap the  button after the adjustment. (👉 4)

When the  button is tapped, "--°C" is displayed, and it starts operation at the last setting temperature.

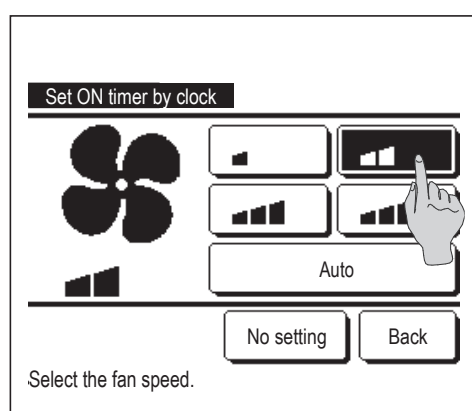

- 7** Tap a desired fan speed.

If the  button is tapped, it operates at the last action. (👉 4)

- 8** After setting the desired contents at the screen of the step 4 on the previous page, tap the  button.

Operation will start at set hours later.

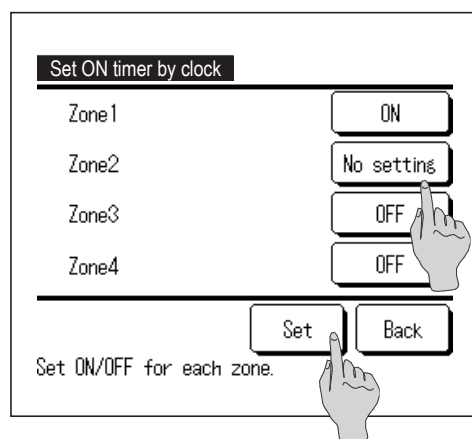

- 9** Tapping the  button makes it possible to perform zone operation settings during timer operation. Set  /  /  (No setting/ OPEN/CLOSE) for each zone at the time of timer working.

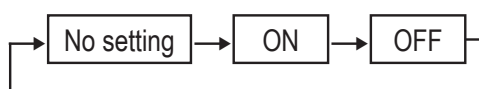

Setting  will operate in the previous zone state at the time of timer working.

After the setting, tap the  button.

The display returns to the previous screen.

## ■ Set OFF timer by clock

Stops the operation of the unit at the set clock time.

- 1 Tap the **Menu** button on the TOP screen and select **Useful functions** ⇒ **Timer** ⇒ **Set OFF timer by clock**.

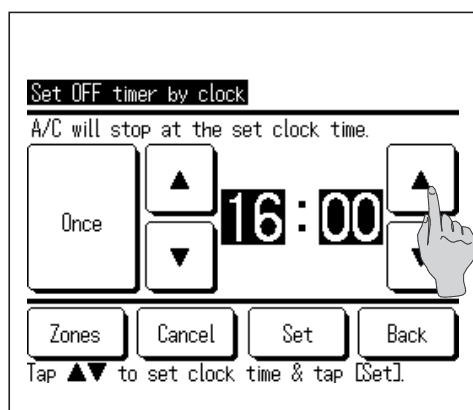

- 2 The Set OFF timer by clock setting screen is displayed.

Select a desired time to stop operation (5-min intervals) with the **▲** **▼** buttons.

- 3 The **Zones** button is displayed when performing zone settings. Tapping the **Zones** button makes it possible to perform zone operation settings at the time of timer working. (The **Zones** button is not displayed when not performing zone settings. Proceed to step 5.)

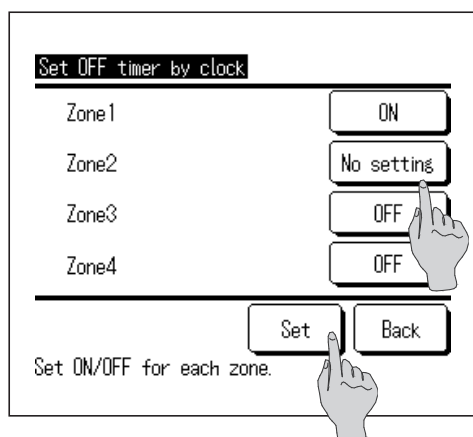

- 4 Tapping the **Zones** button will transition to the zone operation setting screen. Set **No setting** / **ON** / **OFF** (No setting/OPEN/CLOSE) for each zone at the time of timer working.

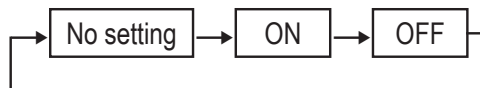

Setting **No setting** will operate in the previous zone state during timer operation.

After the setting, tap the **Set** button.

The display returns to the previous screen.

- 5 After the setting, tap the **Set** button. The display returns to the Timer menu screen. The Set OFF timer by clock can be operated one day (Once) or everyday. If it is operated everyday, tap the **Once** / **Everyday** button to change the display to **Everyday**.

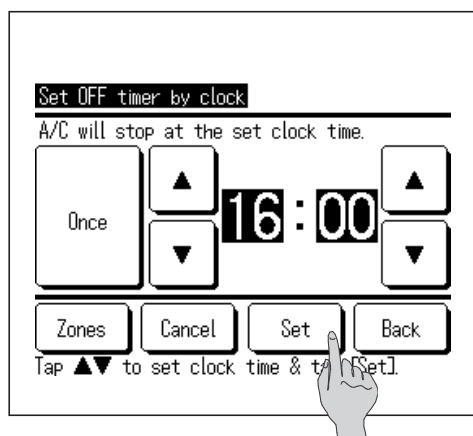

## Confirm

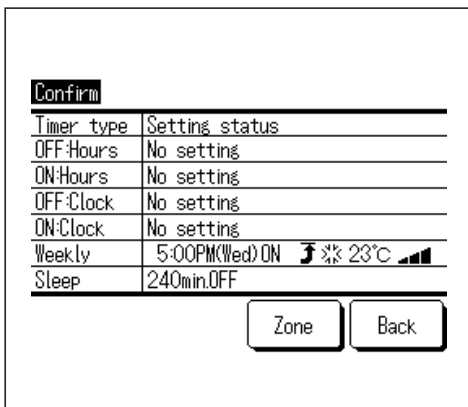

- 1 When you tap the **Confirm** button on the Timer menu screen, the contents of the current timer settings are displayed.

■ When the warming up is set, “” is displayed in front of the operation mode on confirmation screen.

■ The **Zone** button is displayed when performing zone settings. Tapping the **Zone** button will display the set zone states.

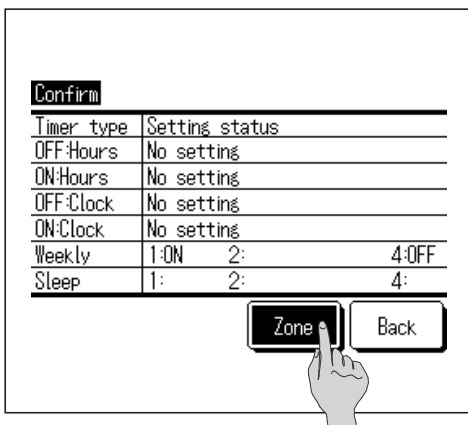

## Weekly timer

You can set four on timer and off timer operations for each day of the week.

### Advice

- The Clock setting ([page 38](#)) must be made when the weekly timer is used.
- The weekly timer can be set from the main R/C only.

- 1 Tap the **Menu** button on the TOP screen and select **Useful functions** ⇒ **Weekly timer**.

Enter the administrator password if the administrator password input screen is displayed.

■ There are cases that the Input password screen is displayed by the Permission/Prohibition setting.  
([page 60](#))

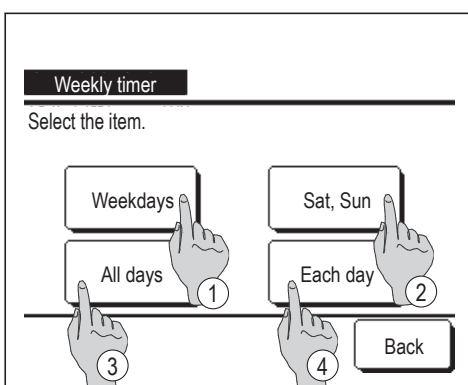

- 2 When the screen to select the setting range, select a day of the week to be set.

- |  |                              |
|--|------------------------------|
| ① Weekdays : Monday - Friday   | } ( <a href="#">page 5</a> ) |
| ② Sat. Sun : Saturday, Sunday  |                              |
| ③ All days : Monday - Sunday   |                              |
| ④ Each day : Moves to the day of the week setting screen. ( <a href="#">page 3</a> ) |                              |

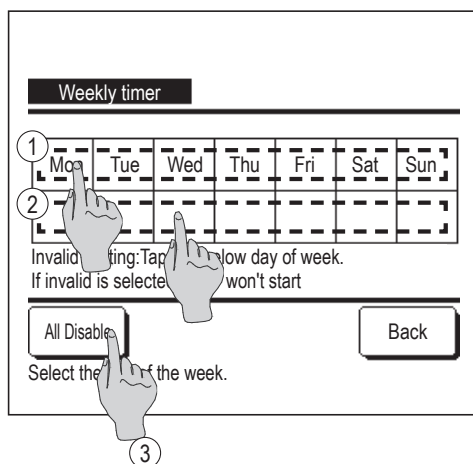

**3** When a desired day of the week ① is tapped on the display, contents of current setting for the day are displayed. (➡5)

**4** For the holiday setting, tap the block ② under the day to switch between “” (the holiday setting) and “(Blank)” (reset).

Timer does not operate on the day set as holiday.

Two or more holidays can be set.

■ To enable the timer on the day set as holiday, it is necessary to reset the holiday setting.

When tapping ③ “All Disable” button, the timer does not operate on all days of the week.

When the timer is used, be sure not to set “All Disable”.

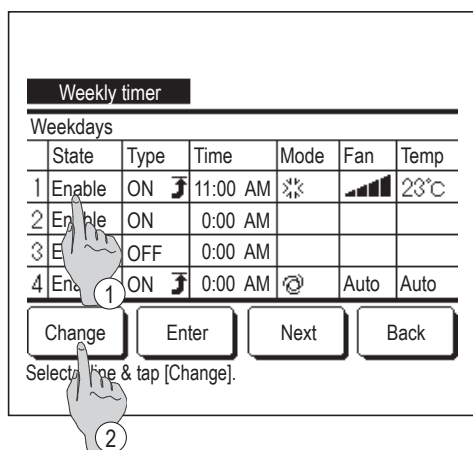

**5** Screen to check contents of current setting is displayed.

When the contents are changed or new setting is added, select a ① setting line No. and tap the ② **Change** button.

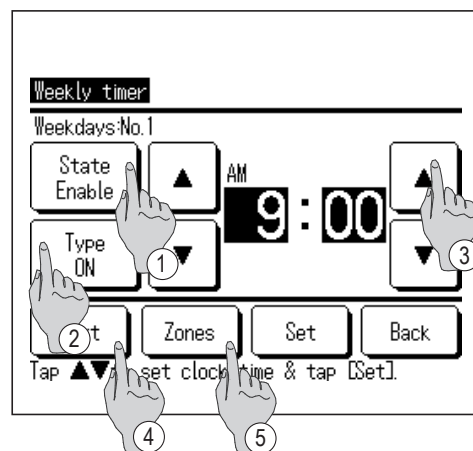

**6** Detail setting screen for the timer setting contents is displayed.

① Tap the **State** button to switch between “State Enable” and “State Disable”.

② Tap the **Type** button to switch between the “OFF timer” and the “ON timer”.

③ Select a desired time (at 5-min intervals) with the buttons.

④ In case of “ON timer” when the **Next** button is tapped, operating conditions at the start of operation can be set. (➡7)

⑤ The **Zones** button is displayed when performing zone settings. Tapping the **Zones** button will display the set zone states. (➡12)

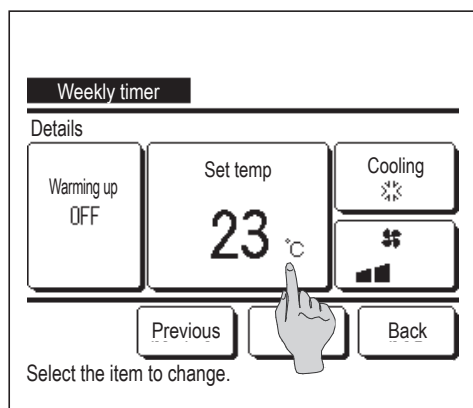

## 7 Set the following operating conditions.

### ① Warming up ON/OFF

(Operation starts 5 to 60 minutes earlier in order to warm up the room temperature closed to the set temp at the set start time of operation.)

### ② Operation mode ... 8

### ③ Set temp ... 9

### ④ Fan speed ... 10

■ Set the operation mode before setting the set temperature.

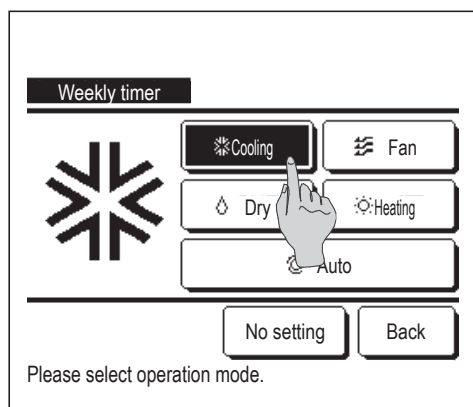

## 8 Tap a desired operation mode.

When the **No setting** button is tapped, it operates with the same operation mode at the last action. ( 7)

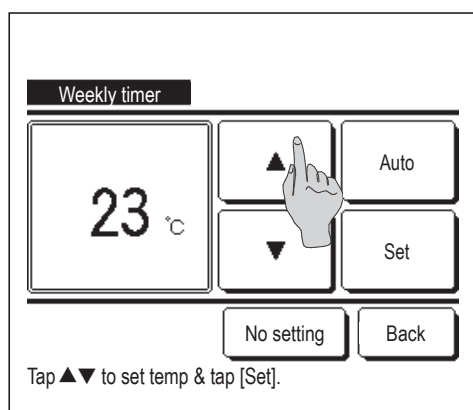

## 9 Select a desired temperature (at 1°C intervals) with the

**▲** **▼** buttons. Or tap the **Auto** button to select the Auto temp setting.

Tap the **Set** button after the selection. ( 7)

When the **No setting** button is tapped, "--°C" is displayed, and it starts operation at the last setting temperature.

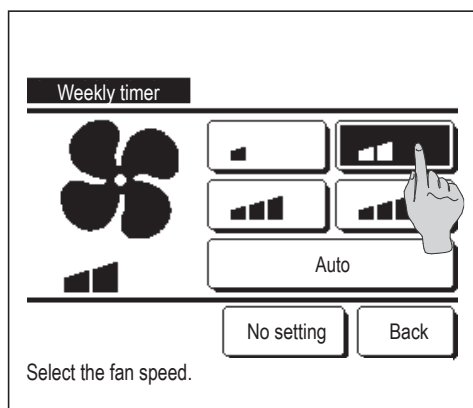

# 10 Tap a desired fan speed.

When the **No setting** button is tapped, starts operation at the last fan speed. (☞ 7)

# 11 After setting desired contents at the screen of 7, tap the **Set** button.

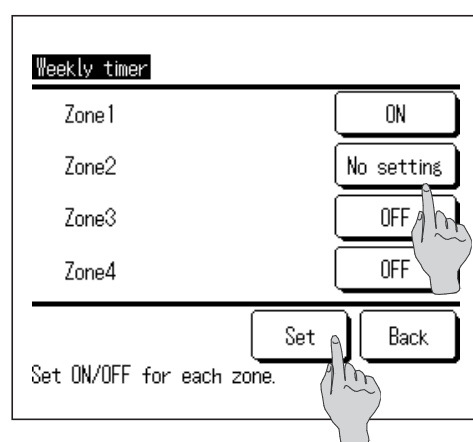

# 12 Tapping the **Zones** button will transition to the zone operation setting screen. Set **No setting** / **ON** / **OFF** (No setting/OPEN/CLOSE) for each zone at the time of timer working.

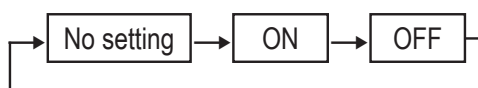

Setting **No setting** will operate in the previous zone state at the time of timer working.

After the setting, tap the **Set** button.

The display returns to the previous screen.

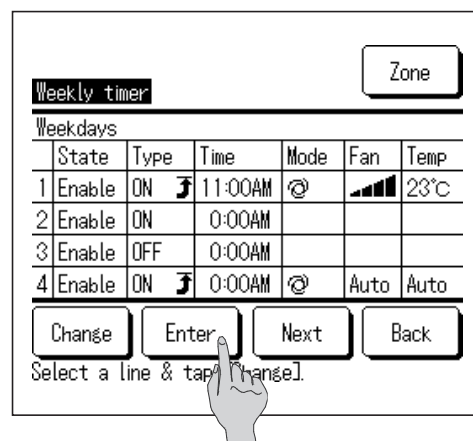

# 13 Display the setting contents check screen. To register the setting, tap the **Enter** button.

(1) In case of group setting (2-①Weekdays, 2-②Sat/Sun, 2-③All days setting), move to the group setting screen. (☞ 13)

(2) In case of the individual setting (2-④Each day setting), save the setting and move to a day of the week selection screen. (☞ 3)

# 14 Display the group setting acknowledge screen. Tap the **Yes** button and save the setting.

The display changes to a day of the week setting check screen after saving. (☞ 3)

When making the setting after changing a day of the week, repeat the setting from the step 3.

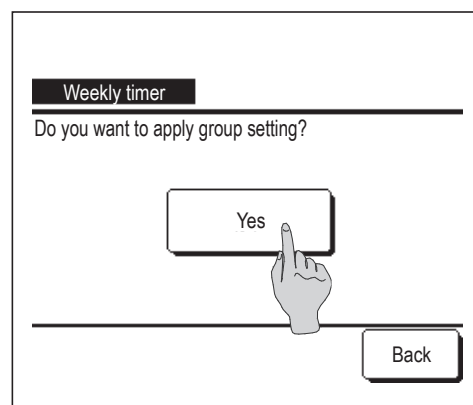

## Home leave mode [Administrator password]

Use this function to maintain the room temperature at a moderate level for avoiding extremely hot or cool after leaving home.

■ Cooling and heating operations are controlled according to the outdoor air temperature.

■ The set temperature and fan speed can be set.

### Advice

- The Clock setting (page 38) must be made when the home leave mode is used.
- The home leave mode can be controlled from the main R/C only.

[To start operation from the **Menu** button]

- 1 Tap the **Menu** button on the TOP screen and select **Useful functions** ⇒ **Home leave**.

The administrator password input screen is displayed.

Input the administrator password.

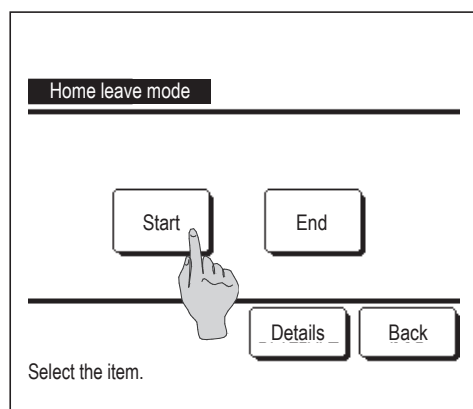

- 2 Display the home leave mode (Start, End) screen.

Tap the **Start** button to start the home leave mode operation.

To stop the home leave mode operation, tap the **End** button.

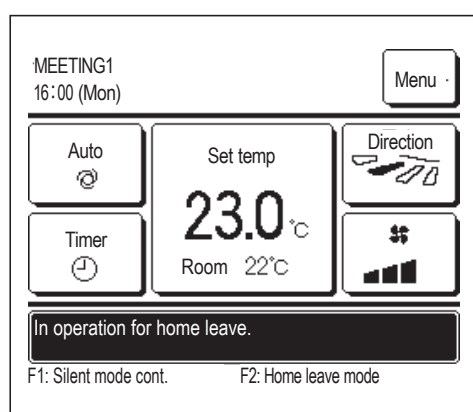

- 3 When the unit is in Home leave mode, "In operation for home leave." will be displayed on the message display.

[To start operation from the **F1**, **F2** switches]

Use the F1/F2 function setting to change the function of the **F1** (**F2**) switch to Home leave mode.

When you press the **F1** (**F2**) switch, the administrator password input screen is displayed.

After you enter the password, the home leave mode will start.

To terminate the home leave mode, press the **F1** (**F2**) button again.



[To change the operation conditions]

- 1 Tap the **Menu** button on the TOP screen and select **Useful functions** ⇒ **Home leave** ⇒ **Details**.

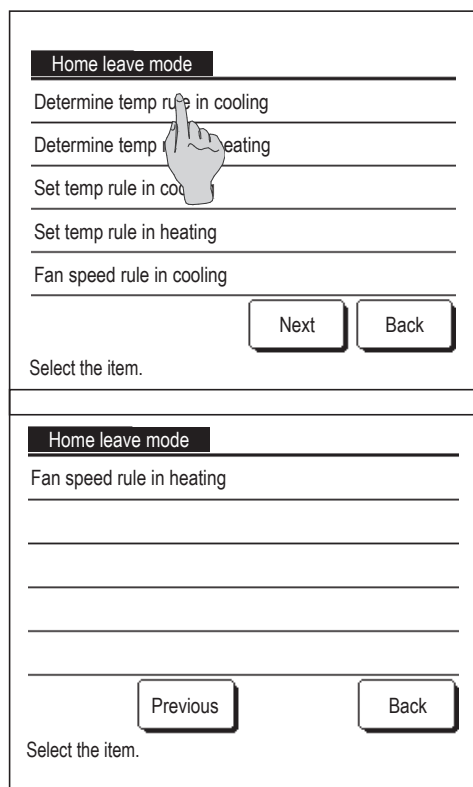

- 2 The Details setting menu is displayed. The following items can be set.

- ① Determine temp rule in cooling: Set the outdoor temperature to judge the operation mode in cooling.  
Allowable setting range: 26°C to 35°C (at 3°C intervals)  
Factory settings: 35°C (👉3)
- ② Determine temp rule in heating: Set the outdoor temperature to judge the operation mode in heating.  
Allowable setting range: 0°C to 15°C (at 3°C intervals)  
Factory settings: 0°C (👉4)
- ③ Set temp rule in cooling: Set the indoor temperature to start operation in cooling.  
Allowable setting range: 26°C to 33°C (at 1°C intervals)  
Factory settings: 33°C (👉5)
- ④ Set temp rule in heating: Set the indoor temperature to start operation in heating.  
Allowable setting range: 10°C to 18°C (at 1°C intervals)  
Factory settings: 10°C (👉6)
- ⑤ Fan speed rule in cooling: Set the fan speed in cooling mode.  
Factory settings: Low (👉7)
- ⑥ Fan speed rule in heating: Set the fan speed in heating mode.  
Factory settings: Low (👉8)

■ Items set at the details setting menu are effective for the operation at the next home leave mode.

- 3 Set the outdoor temperature for the “Determine temp rule in cooling”.  
Select a desired setting temperature (26°C to 35°C, at 3°C intervals) with the **▲** **▼** buttons.  
Tap the **Set** button after the setting.

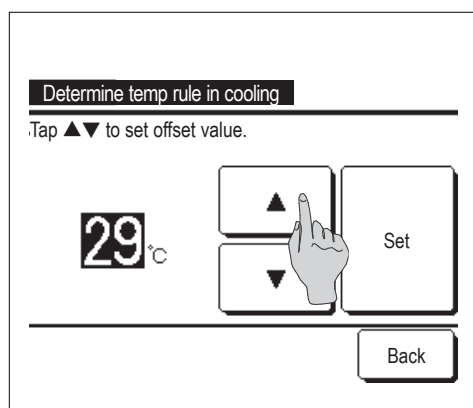

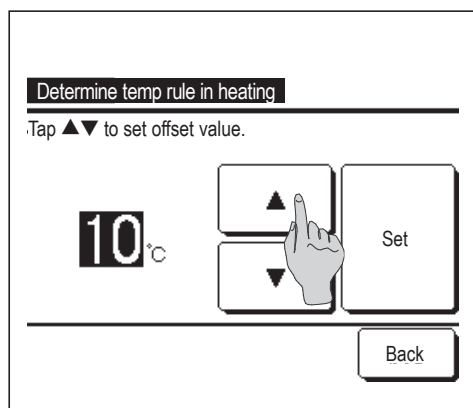

#### 4 Set the outdoor temperature for the “Determine temp rule in heating”.

Select a desired set temp (0°C to 15°C, at 5°C intervals) with the

▲ ▼ buttons.

Tap the Set button after the setting.

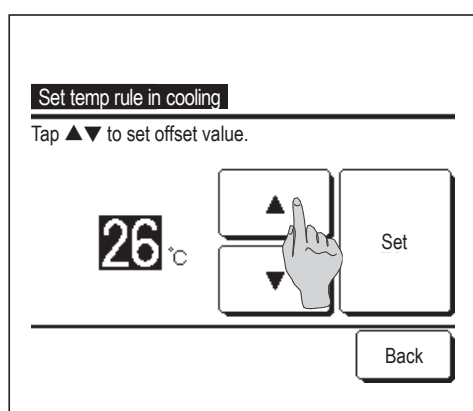

#### 5 Set the indoor temperature to start operation in cooling after setting the “Determine temp rule in cooling”.

Select a desired set temp (26°C to 33°C, at 1°C intervals) with the

▲ ▼ buttons.

Tap the Set button after the setting.

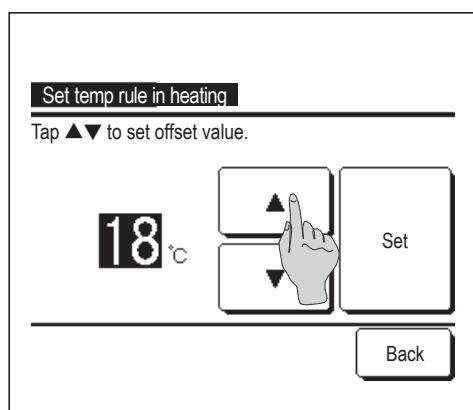

#### 6 Set the indoor temperature to start operation in heating after setting the “Determine temp rule in heating”.

Select a desired set temp (10°C to 18°C, at 1°C intervals) with the

▲ ▼ buttons.

Tap the Set button after the setting.

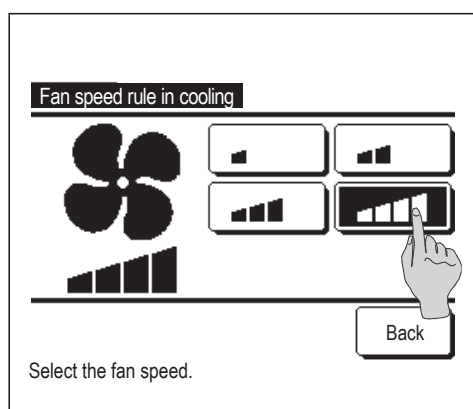

#### 7 Set the fan speed in cooling mode.

Tap a desired fan speed.

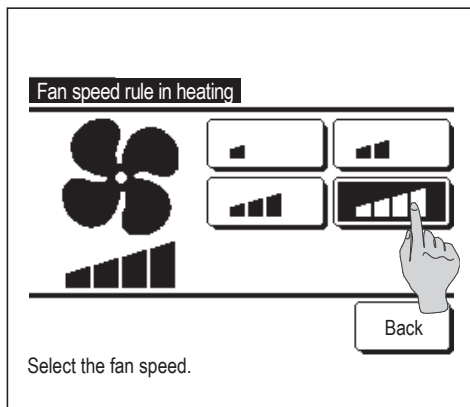

## 8 Set the fan speed in heating mode.

Tap a desired fan speed.

## 9 After the settings of steps 3 to 8, the display returns to the Details setting menu 1.

Tap the **Back** button to return to the home leave mode screen. To start operation, tap the **Start** button.

# Registering favorite settings

Operation mode, set temp, fan speed, fan direction can be registered as Favorite set 1 and Favorite set 2.

Allocating these settings to the **F1** and **F2** switches allows you to perform operations with these registered settings with a single tap of the button (page 71).

Refer to the F1/F2 function setting (page 71) on how to set the **F1** and **F2** switches.

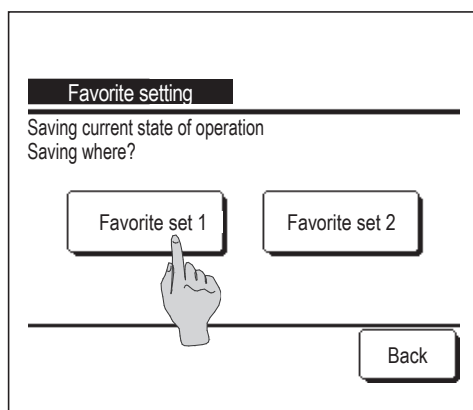

## 1 On the TOP screen, set the desired operation mode, set temp, fan speed, and flap direction.

Tap the **Menu** button on the TOP screen and select **Useful functions** ⇒ **Favorite setting**.

The administrator password input screen is displayed.

Enter the administrator password.

■ You cannot register the favorite settings during high power and energy-saving operations.

## 2 The save location selection screen for favorite settings is displayed.

Select the save location.

If there is any data that was previously saved, that data will be overwritten.

## Favorite setting operation

You can start an operation with the operation mode, set temp, fan speed, flap direction registered to Favorite set 1 and Favorite set 2.

Settings for the operation mode, set temp, fan speed, flap direction can be registered from Favorite setting on the menu (☞ page 57).

Favorite setting operation must be set to the **F1** or **F2** switch (☞ page 71).

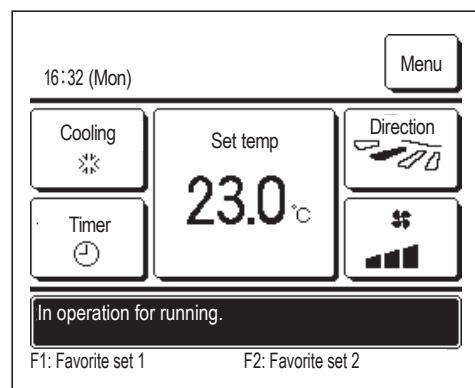

- 1 When you press the **F1** (**F2**) switch, the operation mode, set temp, fan speed, flap direction registered to Favorite set 1 or Favorite set 2 will be enabled.

- Operation will start even if you press the **F1** (**F2**) switch while the unit is stopped.
- You can change the operation mode, set temp, fan speed, flap direction after the operation has started with the favorite setting operation.
- Following power on, the unit starts to operate initially with the following settings for both Favorite set 1 and Favorite set 2.
 

Operation mode	...Cooling
Set temp	...28°C
Fan speed	...3-speed
Flap direction	...Position 2 (☞ page 11)

\*When an FDK with a left/right flap is connected

Left/right flap direction	...Center
3D AUTO	...Disabled
- When Change set temp, Change operation mode, Change flap direction, Change fan speed are restricted by the Permission/Prohibition setting (☞ page 60), restricted items will not be reflected to the Favorite setting operation.

## Administrator settings [Administrator password]

- 1 Tap the **Menu** button on the TOP screen and select **User setting** ⇒ **Administrator settings**.

The administrator password input screen is displayed.

Enter the administrator password.

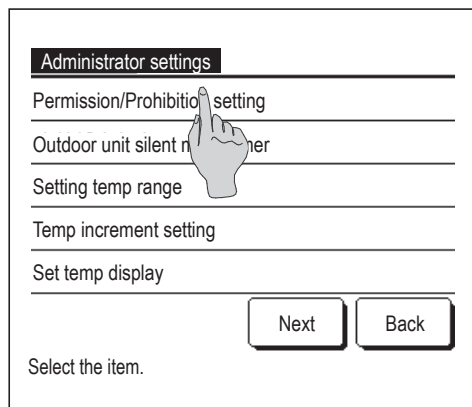

Administrator settings

Permission/Prohibition setting

Outdoor unit silent mode timer

Setting temp range

Temp increment setting

Set temp display

Next Back

Select the item.

- 2 When the administrator setting menu is displayed, tap a desired item.

- Permission/Prohibition setting ... page60
- Outdoor unit silent mode timer ... page61
- Setting temp range ... page62
- Temp increment setting ... page64
- Set temp display ... page64
- R/C display setting ... page65
- Change administrator password ... page70
- F1/F2 function setting ... page71

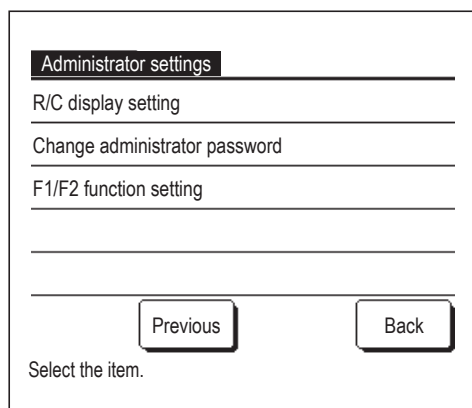

Administrator settings

R/C display setting

Change administrator password

F1/F2 function setting

Previous Back

Select the item.

## ■ Permission/Prohibition setting

- 1 Tap the **Menu** button on the TOP screen and select **User setting** ⇒ **Administrator settings** ⇒ **Permission/Prohibition setting**. The Permission/Prohibition setting menu is displayed.

Permission/Prohibition setting

Bat.set.

Run/Stop

Change set temp

Change operation mode

Change flap direction

Next Back

Select the item.

- 2 Following items can be selected, and the Permission or Prohibition can be set for them.

If the Permission is set, the operation is accepted.

If the Prohibition is set, the message “Invalid request” is displayed for 3 seconds.

Some items may require the administrator password.

### ■ Operation with Prohibition setting

- |                           |   |
|---------------------------|---|
| ① Bat.set                 | ... Can set to permit/prohibit all items from ② to ⑬ at once.                         |
| ② Run/Stop                | ... Run/Stop operation is prohibited.   |
| ③ Change set temp         | ... Change set temp operation is prohibited.  |
| ④ Change operation mode   | ... Change operation mode operation is prohibited.                                    |
| ⑤ Change flap direction   | ... Change flap direction operation is prohibited.                                    |
| ⑥ Individual flap control | ... Administrator password is required for this control.                              |
| ⑦ Change the fan speed    | ... Change fan speed operation is prohibited.   |
| ⑧ High power operation    | ... High power operation is prohibited.   |
| ⑨ Energy-saving operation | ... Energy-saving operation is prohibited.  |
| ⑩ Timer                   | ... Timer setting operation is prohibited.  |
| ⑪ Weekly timer            | ... Administrator password is required for these settings.                            |
| ⑫ Select the language     | ... Administrator password is required for this selection.                            |
| ⑬ Anti draft setting      | ... Administrator password is required when setting anti draft and anti draft ON/OFF. |

Permission/Prohibition setting

Individual flap control

Change the fan speed

High power operation

Energy-saving operation

Timer

Previous Next Back

Select the item.

Permission/Prohibition setting

Weekly timer

Select the language

Anti draft setting

Previous Back

Select the item.

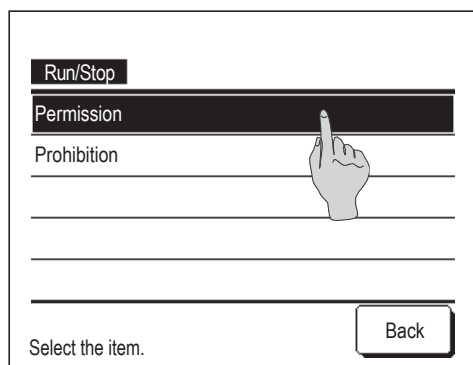

3 Tap **Permission** or **Prohibition** for each item.

## ■ Outdoor unit silent mode timer

Set the period of time to operate the OU with prioritizing the quietness.

When the Outdoor unit silent mode timer setting is Enabled, the silent mode operation starts and ends everyday at the same time until the setting is Disable.

Silent mode operation can be started from an R/C operation without using the timer.

Use Silent mode cont. (page 71) for the **F1** and **F2** switches.

### Advice

- When the Outdoor unit silent mode timer is used, the Clock setting (page 38) must be made.
- The Outdoor unit silent mode timer can be set from the main R/C only.
- The air-conditioner cannot be operated at the maximum capacity during the silent mode operation.

1 Tap the **Menu** button on the TOP screen and select **User setting** ⇒ **Administrator settings** ⇒ **Outdoor unit silent mode timer**.

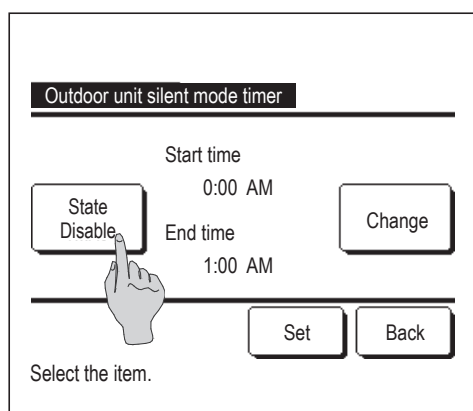

2 The Outdoor unit silent mode timer setting screen is displayed.

If it is OK that the Silent mode operation is performed at the start and end time displayed on the screen, tap the **State** button to select "State Enable".

■ When the **State** button indicates "State Disable", the Outdoor unit silent mode timer is not controlled.

After changing to a desired setting, tap the **Set** button.

To change the start time or the end time, tap the **Change** button.

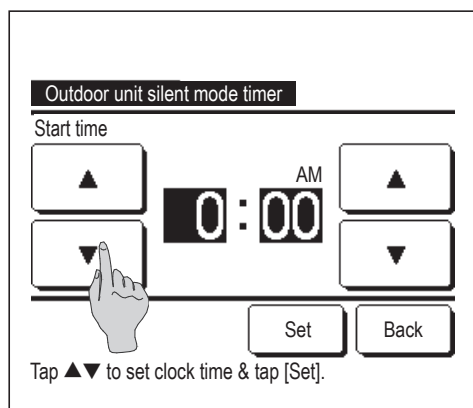

### 3 Set the start time for the Outdoor unit silent mode timer.

Select a desired time (at 5-min intervals) with the ▲ ▼ buttons.

If the [Set] button is tapped after setting the start time, the display changes to the end time setting screen. Set a desired time (at 5-min intervals) for the end time and tap the [Set] button.

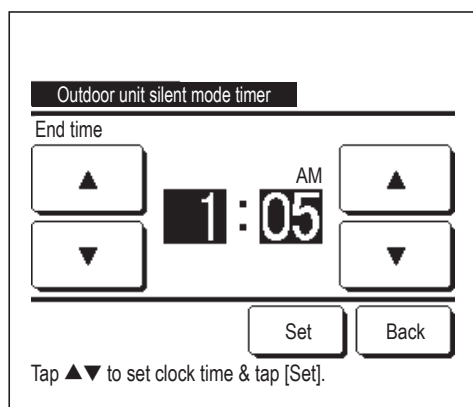

## ■ Setting temp range

Limited range of setting temperature in the heating or the cooling operation can be selected.

- 1 Tap the [Menu] button on the TOP screen and select [User setting] ⇒ [Administrator settings] ⇒ [Setting temp range].

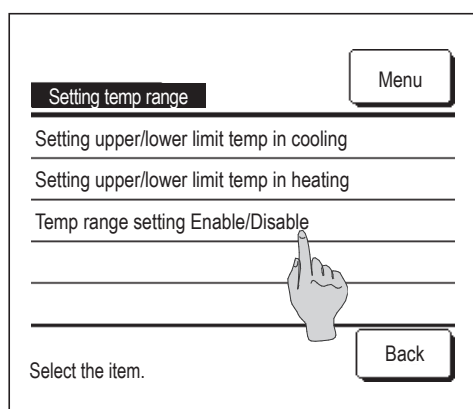

### 2 Setting temp range menu screen is displayed.

- ① Setting upper/lower limit temp in cooling (🔍 2)  
... Set the range of setting temperature in the cooling operation.  
(Including the Dry and Auto operations)
- ② Setting upper/lower limit temp in heating (🔍 3)  
... Set the range of setting temperature in the heating operation.
- ③ Temp range setting Enable/Disable (🔍 4)  
... Set whether the limit on the setting temperature range is enabled or disabled.



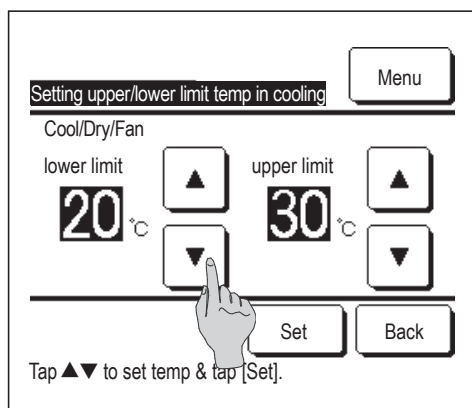



### 3 Set the range of setting temperature in the cooling operation.

Select at desired lower and upper limit temperatures (at 1°C intervals) with the   buttons.

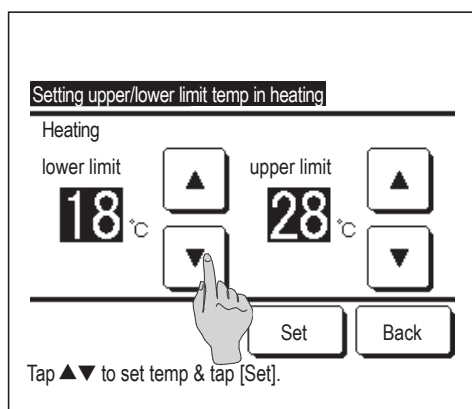
After Selecting the desired settings, tap the  button.



### 4 Set the range of setting temperature in the heating operation.

Select desired lower and upper limit temperatures (at 1°C intervals) with the   buttons.

After selecting the desired settings, tap the  button.

■ Setting temperatures can be set in the following ranges.

	Lower limit value	Upper limit value
Cooling/Dry/Auto	16 to 28°C	30 to 35°C
Heating	10 to 22°C	22 to 30°C
Mid temperature cooling	10 to 18°C	22 to 30°C

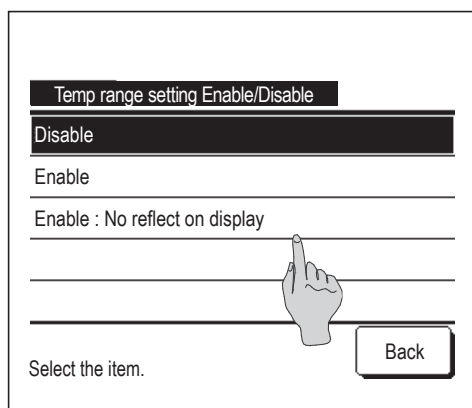

### 5 Select the control contents of restriction on the setting temperature range.

#### ① Disable

... Restriction on the setting temperature range is disabled.

#### ② Enable

... The operation is restricted within the set temperature range.

#### ③ Enable: No reflect on display

... The set temperature on the R/C can be displayed beyond the set temperature range but actual operation is restricted within the set temperature range.

### Advice

- Over-cooling during the cooling operation or over-heating during the heating operation is not economical.
- It is recommended to set the temperature range a little higher in the cooling operation or a little lower in the heating operation.

## ■Temp increment setting

Temperature increment for the change of the set temp can be changed.

- 1 Tap the **Menu** button on the TOP screen and select **User setting** ⇒ **Administrator settings** ⇒ **Temp increment setting**.

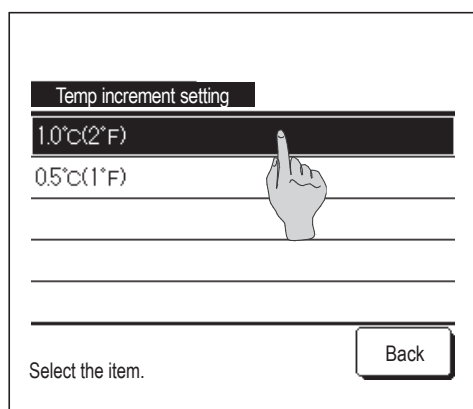

- 2 The Temp increment setting screen is displayed.

Tap a desired temperature increment.

- ① 1.0°C..... Setting temperature can be set at 1.0°C intervals.  
(ex. ...⇔ 24.0°C ⇔ 25.0°C ⇔ 26.0°C ⇔...)
- ② 0.5°C..... Setting temperature can be set at 0.5°C intervals.  
(ex. ...⇔ 24.0°C ⇔ 24.5°C ⇔ 25.0°C ⇔...)

## ■Set temp display

Set temp displayed on the TOP screen can be changed.

- 1 Tap the **Menu** button on the TOP screen and select **User setting** ⇒ **Administrator settings** ⇒ **Set temp display**.

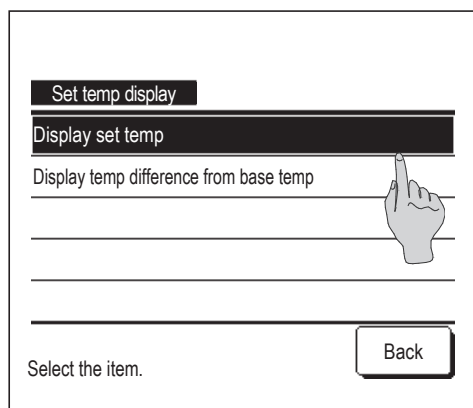

- 2 The Set temp display menu is displayed.

- ① Display set temp  
... Set temp is displayed.
- ② Display temp difference from base temp  
... The difference from the base temperature is displayed. When you select the Display temp difference from base temp, the Base temp setting screen is displayed (➡2).

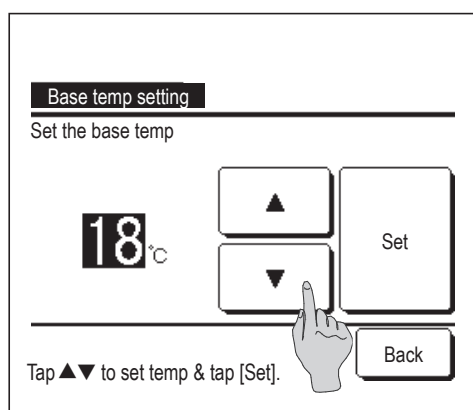

- 3 Set the base temperature.

## R/C display setting

Contents of display on the R/C can be changed.

- 1 Tap the **Menu** button on the TOP screen and select **User setting** ⇒ **Administrator settings** ⇒ **R/C display setting**.

R/C display setting

Room name

Name of IU

Indoor temp display

Error code display

Heating standby display

Next Back

Select the item.

- 2 The R/C display setting menu screen is displayed.

- ① Room name ... page 66
- ② Name of I/U ... page 66
- ③ Indoor temp display ... page 67
- ④ Error code display ... page 68
- ⑤ Heating standby display ... page 68
- ⑥ Defrost operation display ... page 69
- ⑦ Auto cooling/heating display ... page 69
- ⑧ Display temp of R/C, Room, Outdoor ... page 70
- ⑨ Zone name ... page 15

R/C display setting

Defrost operation display

Auto cooling/heating display

Display temp of R/C, Room, Outdoor

Zone name

Previous Back

Select the item.

## ① Room name

Set the room name to be displayed on the TOP screen.

- 1 Tap the **Menu** button on the TOP screen and select **User setting** ⇒ **Administrator settings** ⇒ **R/C display setting** ⇒ **Room name**.

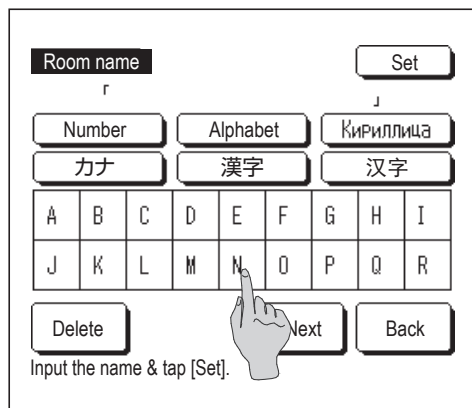

- 2 The Room name input screen is displayed.

The room name can be set with up to 9 2-byte letters (18 1-byte letters).

You can enter alphanumeric, Japanese Kana, Kanji, Cyrillic, or Chinese characters.

Tap the **Previous** or **Next** button to display next character group.

When you have finished inputting the room name, tap **Set**.

The room name is displayed on the TOP screen.

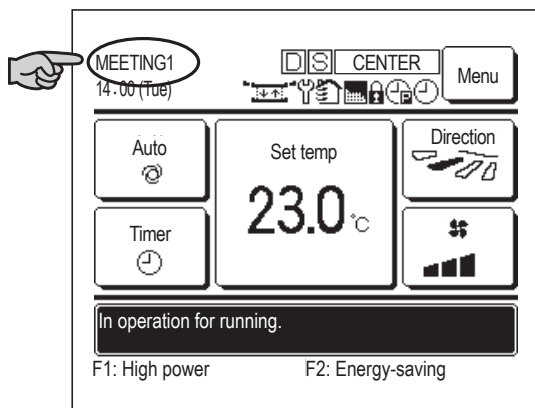

## ② Name of IU

Set the name of IU to be added to the IU address button.

- 1 Tap the **Menu** button on the TOP screen and select **User setting** ⇒ **Administrator settings** ⇒ **R/C display setting** ⇒ **Name of IU**.

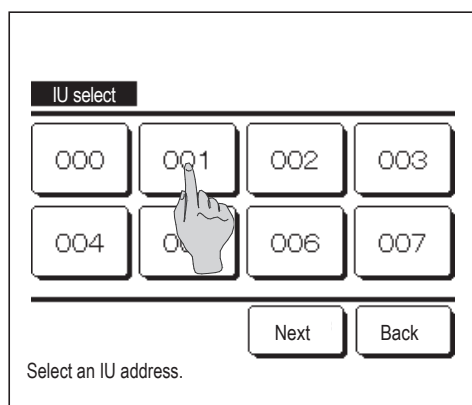

- 2 The IU select screen is displayed.

When two or more IUs are connected to the R/C, a list of IUs is displayed. Tap the button for the IU (address number) to set the name.

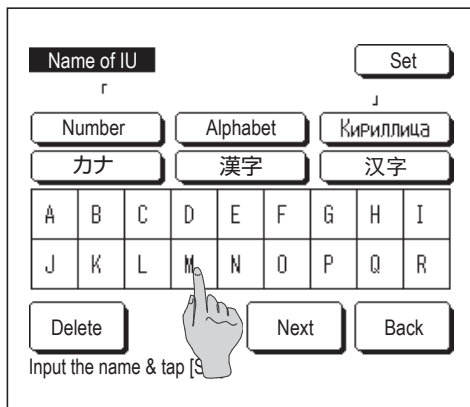

- 3** When the letter selection screen is displayed same as at the setting of the name of R/C (☞ 66), enter letters.

The name of IU can be entered up to 4 2-byte (8 1-byte) letters.

When the input is over, tap the **Set** button. The text “The registration is completed.” is displayed, and the settings are completed.

### ③ Indoor temp. display

Select ON/OFF for the room temperature display.

- 1** Tap the **Menu** button on the TOP screen and select **User setting** ⇒ **Administrator settings** ⇒ **R/C display setting** ⇒ **Indoor temp display**.

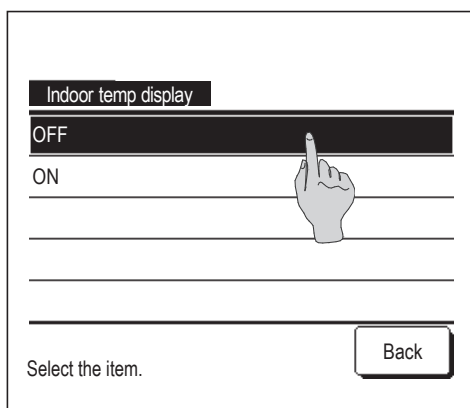

- 2** The Indoor temp display screen is displayed.

On the Indoor temp display screen, select ON/OFF of the display. When R/C sensor setting is enabled, the room temperature (R/C) is displayed (refer to the installation manual on how to make these settings).

OFF ... Room temperature is not displayed on the TOP screen.

ON ... Room temperature is displayed on the TOP screen.

When R/C sensor setting is disabled, the room temperature ○°C is displayed.

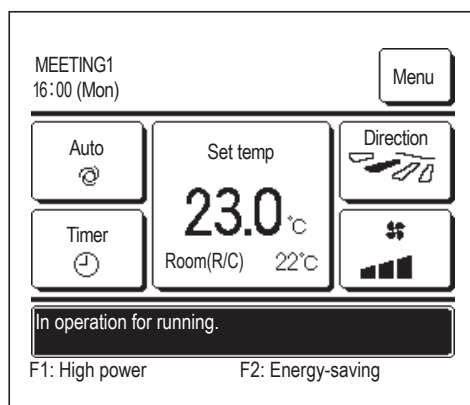

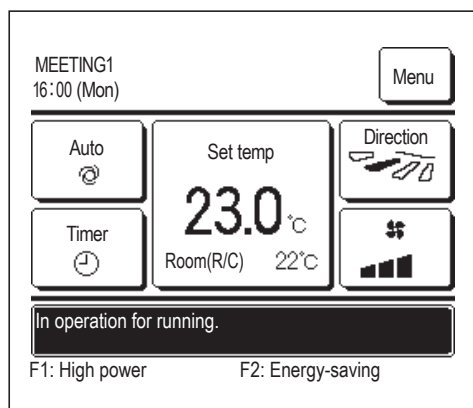

When R/C sensor setting is enabled, the room temperature (R/C)  $\circ\text{C}$  is displayed (refer to the installation manual on how to make these settings).

#### ④ Error code display

Select ON/OFF for the Error code display.

- 1 Tap the **Menu** button on the TOP screen and select **User setting**  $\Rightarrow$  **Administrator settings**  $\Rightarrow$  **R/C display setting**  $\Rightarrow$  **Error code display**.

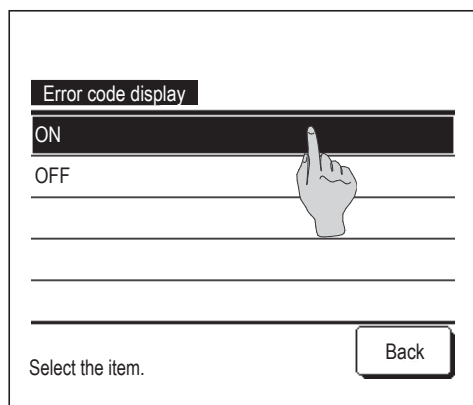

- 2 The Error code display screen is displayed.

On the Error code display selection screen, select ON/OFF of the display.

**ON** ... When there is any error on the unit, the message “Prot.stp.ON E  $\circ$  Touch here for contact. History can be checked from Menu.” is displayed on the TOP screen message display.

**OFF** ... The message is not displayed even if there is any error.

#### ⑤ Heating standby display

Select ON/OFF for the Heating standby display.

- 1 Tap the **Menu** button on the TOP screen and select **User setting**  $\Rightarrow$  **Administrator settings**  $\Rightarrow$  **R/C display setting**  $\Rightarrow$  **Heating standby display**.

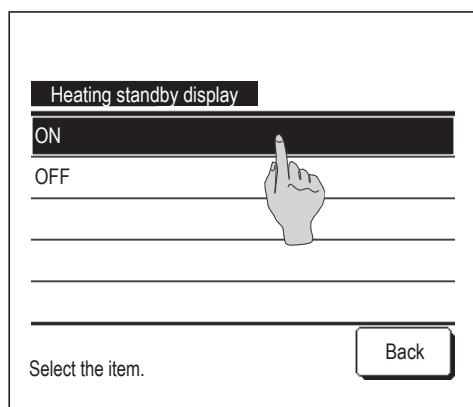

- 2 The Heating standby display selection screen is displayed.

On the Heating standby display selection screen, select ON/OFF of the display.

The heating standby control is operated to prevent blowing of cold air at the start of heating operation.

**ON** ... The message “Heating standby” is displayed during the heating standby control.

**OFF** ... The message “Heating standby” is not displayed.

## ⑥ Defrost operation display

When frost on the OU heat exchanger is accumulated and the conditions for start defrosting are established, the defrost operation control is performed automatically. Select ON/OFF for the Defrost operation display.

- 1 Tap the **Menu** button on the TOP screen and select **User setting** ⇒ **Administrator settings** ⇒ **R/C display setting** ⇒ **Defrost operation display**.

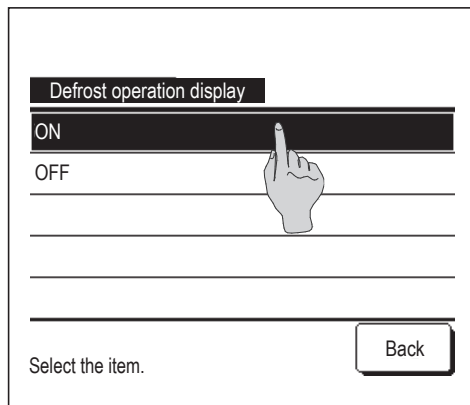

- 2 The Defrost operation display selection screen is displayed.

On the Defrost operation display selection screen, select ON/OFF of the display. The heating standby control is operated to prevent blowing of cold air at the start of a heating operation.

ON ... The message “Defrost operation” is displayed during the defrost operation.

OFF ... The message “Defrost operation” is not displayed.

## ⑦ Auto cooling/heating display

Select ON/OFF for the display of the Auto cooling or heating.

- 1 Tap the **Menu** button on the TOP screen and select **User setting** ⇒ **Administrator settings** ⇒ **R/C display setting** ⇒ **Auto cooling/heating display**.

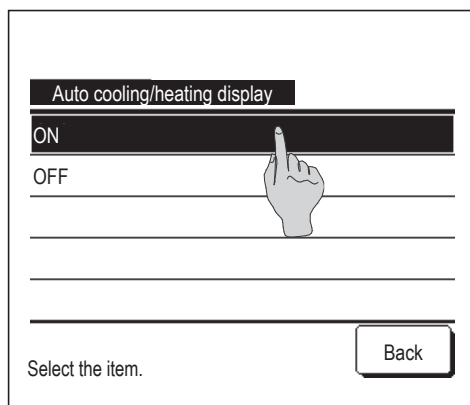

- 2 The Auto cooling/heating display selection screen is displayed.

On the Auto cooling/heating display selection screen, select ON/OFF of the display.

ON ... The message “Auto Cooling” or “Auto Heating” is displayed on the “Change operation mode” button at the TOP screen during the auto mode operation.

OFF ... The message “Auto” is displayed on the “Change operation mode” button at the TOP screen.

## ⑧ Display temp of R/C, Room, Outdoor

Select ON/OFF for the display of the R/C sensor temperature, room temperature and outdoor temperature.

- 1 Tap the **Menu** button on the TOP screen and select **User setting** ⇒ **Administrator settings** ⇒ **R/C display setting** ⇒ **Display temp of R/C, Room, Outdoor**.

- 2 The Display temp of R/C, Room, Outdoor selection screen is displayed.

On the Display temp of R/C, Room, Outdoor selection screen, select ON/OFF of the display.

ON ... Each temperature is displayed on the TOP screen.

OFF ... These temperatures are not displayed on the TOP screen.

## ■ Change administrator password

Administrator password can be changed.

- 1 Tap the **Menu** button on the TOP screen and select **User setting** ⇒ **Administrator settings** ⇒ **Change administrator password**.

- 2 The Change administrator password screen is displayed.

Enter the password (4-digit number) and tap the **Set** button.

- 3 The password change confirmation screen is displayed for 3 seconds, and the display returns to the administrator settings menu screen.



## F1/F2 function setting

Use the **F1** and **F2** switches to change the functions to operate.

- 1 Tap the **Menu** button on the TOP screen and select **User setting** ⇒ **Administrator settings** ⇒ **F1/F2 function setting**.

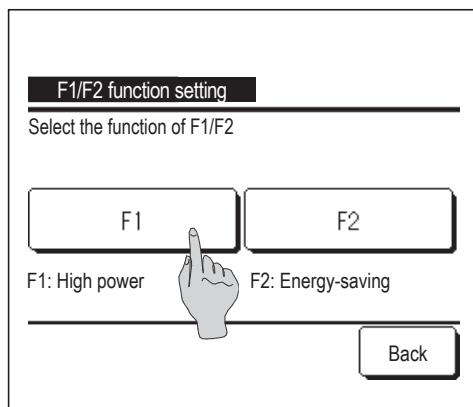

- 2 The F1/F2 function setting screen is displayed.

On the F1/F2 function setting screen, tap the side (**F1** or **F2** switch) you desire to change.

The currently set functions are displayed below the buttons.

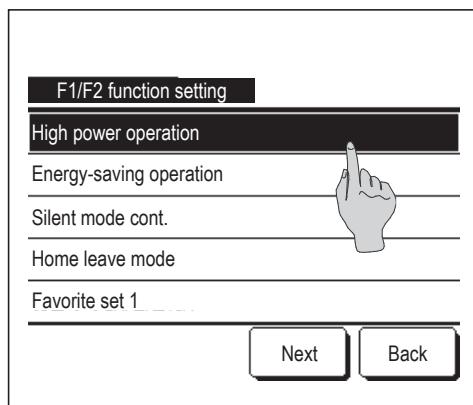

- 3 Select the function to set to the **F1** or **F2** switch.

The following functions can be selected.

- High power operation ... [page 18](#)
- Energy-saving operation ... [page 19](#)
- Silent mode control ... [page 72](#)
- Home leave mode ... [page 54](#)
- Favorite setting operation ... [page 58](#)
- Filter sign reset ... [page 74](#)
- Anti draft ON/OFF ... [page 17](#)

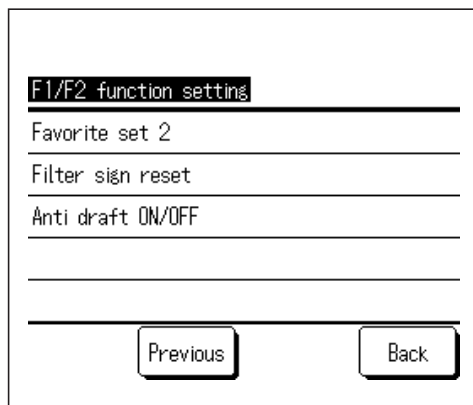

## Silent mode control

The OU is controlled with priority on quietness. You can start/stop the silent mode control.

### 【Starting control with Menu button】

- 1 Tap the Menu button on the TOP screen and select Useful functions ⇒ Silent mode control

The administrator password input screen is displayed.

Enter the administrator password.

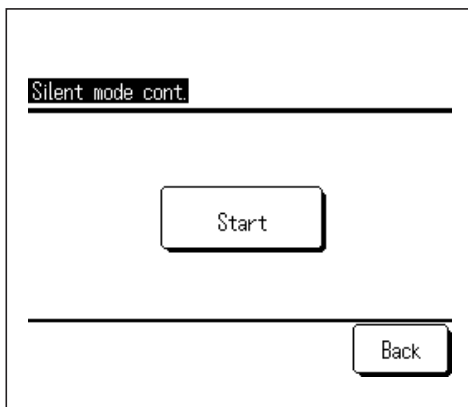

- 2 The Silent mode control (Start/End) screen is displayed.

Tap the Start button to start the silent mode control.

To terminate the silent mode control, tap the End button.

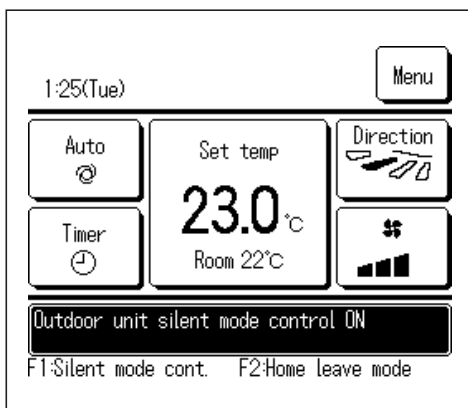

- 3 During silent mode control, “Outdoor unit silent mode control ON” will be displayed on the message display.

- Silent mode control will not be disabled even if you press the Run/Stop switch.
- When the sub R/C is set, the silent mode control cannot be used.
- During silent mode control, operation with maximum capacity is not allowed.

### 【Starting control with F1 or F2 switch】

Change the F1 (F2) switch function to the silent mode control in the F1 (F2) function setting.

When you press the F1 (F2) switch, the administrator password input screen is displayed. After you enter the password, the silent mode control will start.

To terminate the silent mode control, press the F1 (F2) switch again.

- This operation is to select enable/disable of silent mode control. You cannot start the operation with the F1 (F2) switch during stop. Start the operation with the Run/Stop switch.

## Select the language

Select the language to be displayed on the R/C.

### 【Selecting the language with the button】

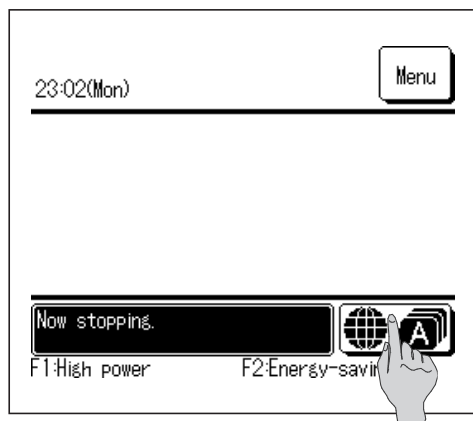

- 1 Tap the  button on the TOP screen while the air conditioner is stopped.

■ Depending on how the Permission/Prohibition setting (page 60) is set, the administrator password input screen may be displayed.





- 2 The menu for select the language is displayed.

Select the language to be displayed on the R/C and tap the  button.

You can select from the following languages:

English/German/French/Spanish/Italian/Dutch/Turkish/Portuguese/  
Russian/Polish/Japanese/Chinese

### 【Selecting the language with the button】

- 1 Tap the  button on the TOP screen and select  ⇒ 

■ Depending on how the Permission/Prohibition setting (page 60) is set, the administrator password input screen may be displayed.

- 2 The menu for setting the language selection is displayed.

Select a language to be displayed on the R/C and tap the  button.

## Filter sign reset

In order to announce the time for cleaning of the air filter, the message of “Filter cleaning. Touch here.” is displayed when the cumulative operation time of the IU reaches the preset time. After you clean the filter, you must reset the operation time.

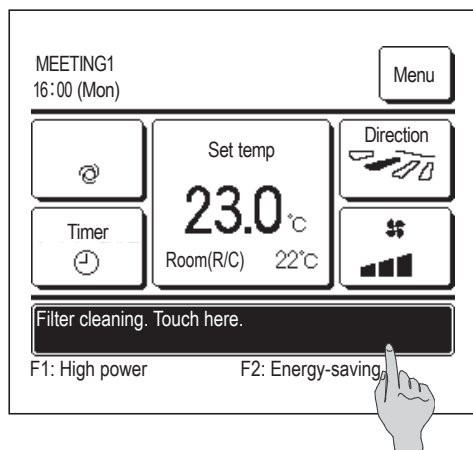

### 1 Tap the message display on the TOP screen.

You can also perform filter sign reset from the menu before the message “Filter cleaning. Touch here.” is displayed.

Tap the **Menu** button on the TOP screen and select **Filter** ⇒ **Filter sign reset**.

You can also use the **F1** and **F2** switches to perform this operation.

Set the filter sign reset to the **F1** (**F2**) switch using the Switch function (page 71) to perform this operation.

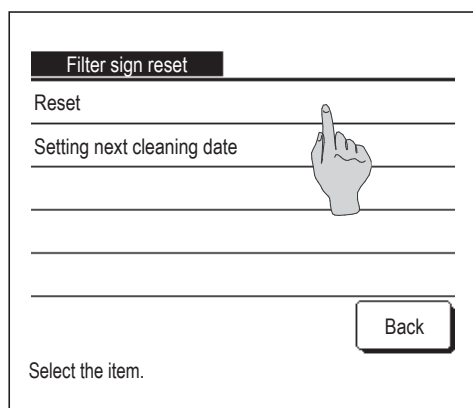

### 2 The filter sign reset menu screen is displayed.

To reset the filter sign, tap **Reset**. (page 3)

To set next cleaning date, tap **Setting next cleaning date**. (page 4)

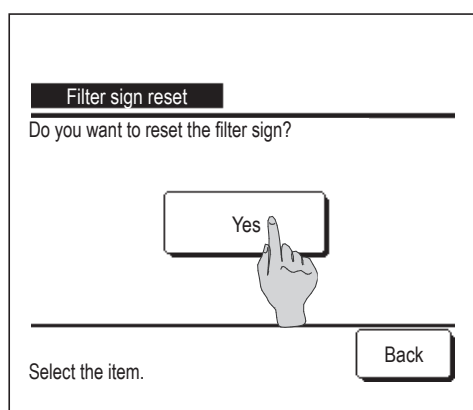

### 3 Acknowledge screen for the Filter sign reset screen is displayed.

Tap the **Yes** button.

If you do not want to reset, tap the **Back** button.

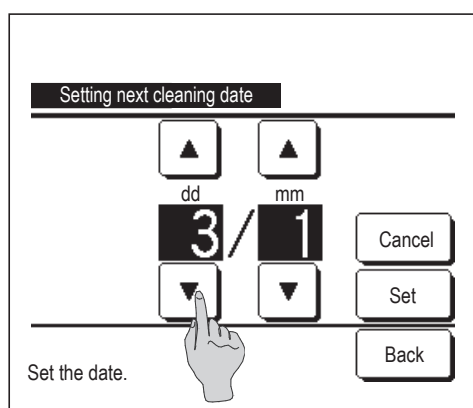

### 4 The Setting next cleaning date screen is displayed.

Select a desired date with the **▲** **▼** buttons and tap the **Set** button.

The message of “Filter cleaning. Touch here.” will be displayed on the set date.

#### Advice

· When setting next cleaning date, the Clock setting must be made. (page 38)

## 5. Maintenance of unit and LCD

### Maintenance of unit and LCD

- Wipe the surface of LCD and main body of the remote control with a dry cloth when cleaning is required.
- If the dirt on the surface cannot be removed, soak the cloth in neutral detergent diluted with water, squeeze the cloth tightly, and clean the surface. Wipe the surface with a dry cloth then.

#### Note

Do not use any paint thinner, organic solvent, or strong acid.

#### Warning



**Do not use flammable materials (e.g. hairspray or insecticide) near the unit.**

**Do not clean the unit with benzene or paint thinner.**

It could cause crack damage to the unit, electric shocks, or fire.

## 6. Useful information

### Contact company & Error display

If any error occurs on the air conditioner, the “Unit protection stop” is indicated on the message display. Take the following measures, stop the operation and consult your dealer.

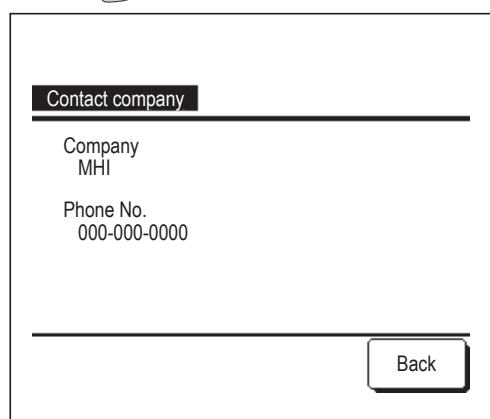
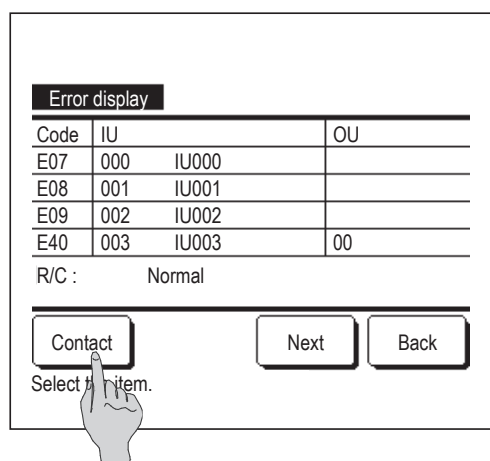
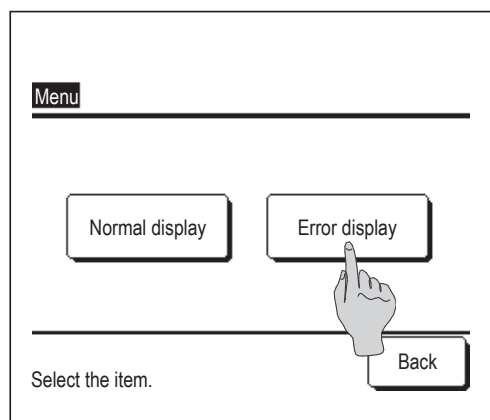
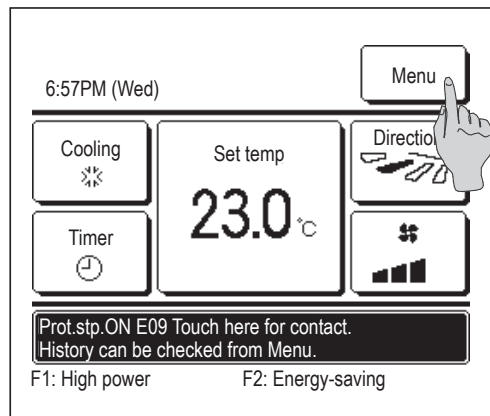

- 1 The “Unit protection stop” is displayed on the message display.  
Tap the **Menu** button.

When the **Normal display** and **Error display** button is displayed, tap the **Error display** button.

- 2 Contents of error are displayed.

After checking the error contents (Code), tap the **Contact** button.

Or tap the **Normal display** button on the previous screen and select the “Contact company” on the menu screen and tap it.

- 3 Company information (Name and phone No. of contact) is displayed.

This is displayed when it has been preset by your dealer.

## 7. Notice of inspection date

If the next service date is set on the Service & Maintenance menu by your dealer, the following screen is displayed for 5 seconds at the start of operation and for 20 seconds from the end of operation on the beginning of the month which includes the set date.

When this screen is displayed, contact your dealer.

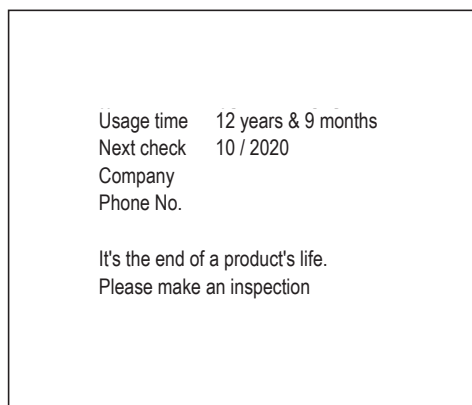
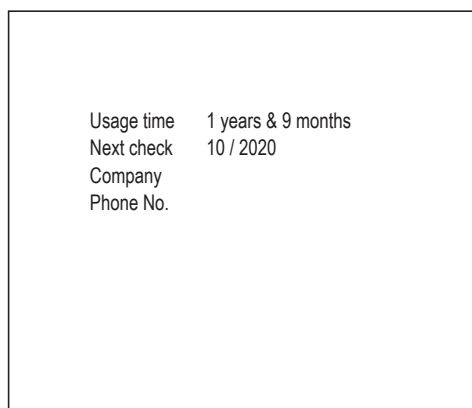

When the period of use exceeds 10 years, the screen shown at left is displayed.

When this screen is displayed, contact your dealer.

## 8. Message display

During operation, the following messages will be displayed on the message display to notify the current condition of the unit.

### ■ “Standby. Wait a while.” displayed

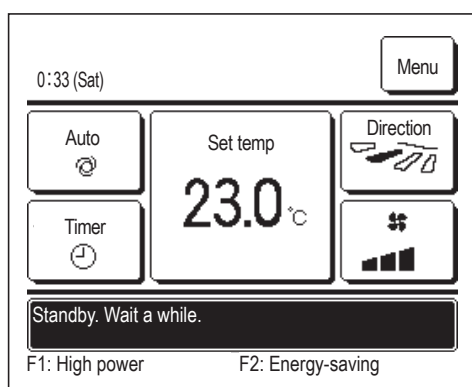

The message “Standby. Wait a while.” may be displayed (maximum of 30 minutes) on the R/C during the first operation following a breaker power on or power loss.

This does not indicate a failure; it is caused by the cooling machine oil protect control that is activated in order to protect the compressor. Please wait until the message “Standby. Wait a while.” disappears.

## ■ “In operation for defrosting.” display

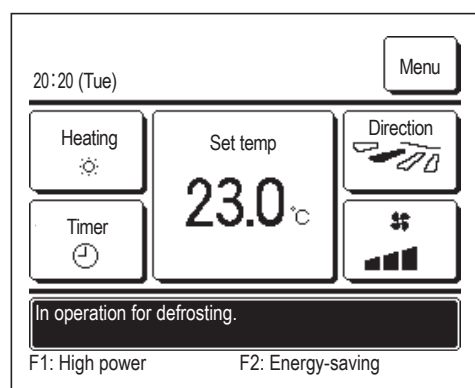

When frost forms on the OU, the heating performance will decrease. This will cause the unit to automatically switch to defrost operation, and hot air will stop blowing out from the IO.

The message “In operation for defrosting.” will be displayed on the message display. After the defrost operation has completed, “In operation for defrosting.” will disappear, and the unit will switch back to its normal heating operation.

## ■ “In operation for heating standby.” displayed

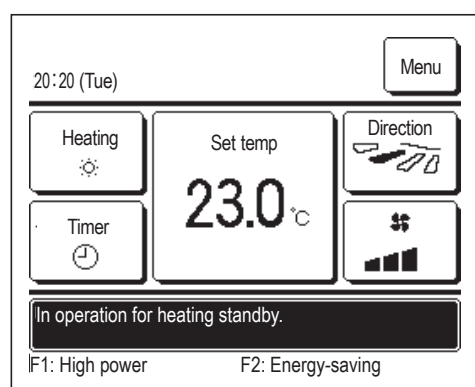

To prevent any cold air blowing out from the IO at the start of a heating operation, the unit stops the fan and displays “In operation for heating standby.” on the message display.

When the unit is ready to blow out hot air, the message “In operation for heating standby.” disappears, and the unit will start heating operation.

## ■ “In operation for warming up.” display

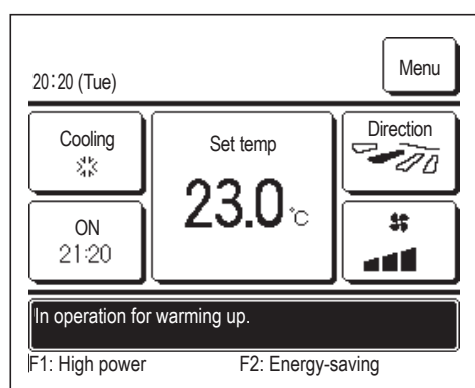

When you select to enable warming up by the Set ON timer by hour (🕒 page 44) or Set ON timer by clock (🕒 page 47), the operation will start 50 to 60 minutes earlier, which is predicted based on the previous warm up operation, so that the room will be close to the set temp by the time it reaches the operation start time.

During the warm up operation, the message “In operation for warming up.” will be displayed on the message display.

This message will disappear at the time set for operation start.



## ■ “In operation for rotation.”, “In operation for capacity back-up”, “In operation for fault back-up” displays

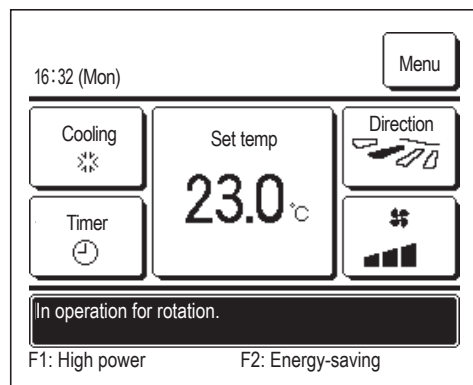

When rotation, capacity back-up, or fault back-up operation is enabled during installation, a message indicating the operation that is set and running will be displayed on the message display.

Refer to the installation manual on how to make these settings.

## ■ “Invalid request. Central control active.” display

When the unit is controlled through a central control device (not included), and you performed an operation other than the followings, the message “Invalid request. Central control active.” is displayed.

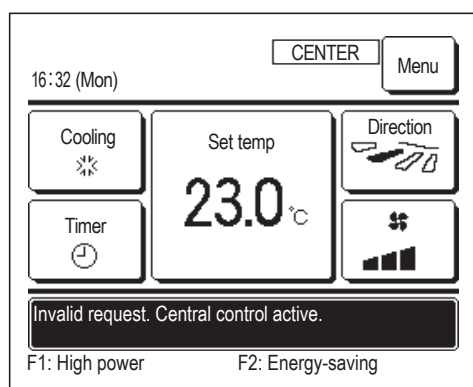

This does not indicate a failure; the message indicates that the unit is controlled through a central control device.

[Operations allowed during central control]

- Filter sign reset
- Administrator settings

## ■ “In temporary stop mode”, “In forced thermostat OFF”, “In setting temperature shift” displays

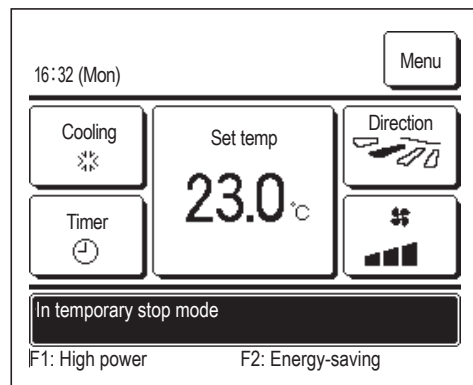

These messages will be displayed when the unit is operated through IO external input.

This does not indicate a failure; the message indicates that the unit is operated through IO external input.

## ■“OU silent operation by external input” display

The message “OU silent operation by external input” will be displayed when silent mode control is operated through a central control device (not included) or an IO external input (not included).

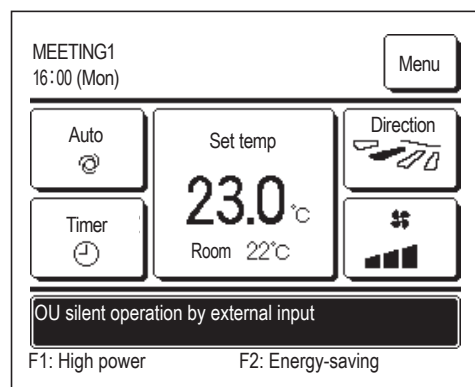

When “OU silent operation by external input” is displayed, the operation performed will be the same as the silent mode control (page 72) performed from the R/C.

During silent mode control, operation with maximum capacity is not allowed.

## ■“There is a information of maintenance. Check the content from [Menu].” display

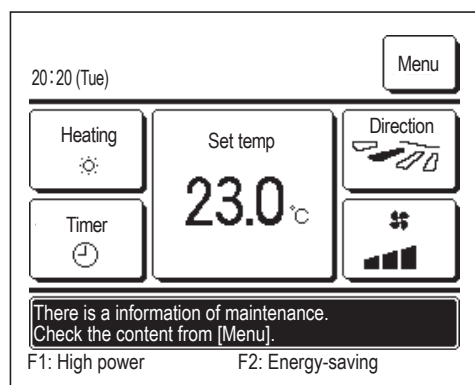

To notify any maintenance information related to the product, the message “There is a information of maintenance. Check the content from [Menu].” may be displayed in the message display.

When this message is displayed, tap the Menu button. The maintenance description will be displayed.

Contact the dealer/company shown as the Contact company (page 76) and notify the details (code) of required maintenance.

## ■“Back-up” display

When any error occurs on the OU but its operation is continued as an emergency measure, the message of “Back-up” will be displayed.

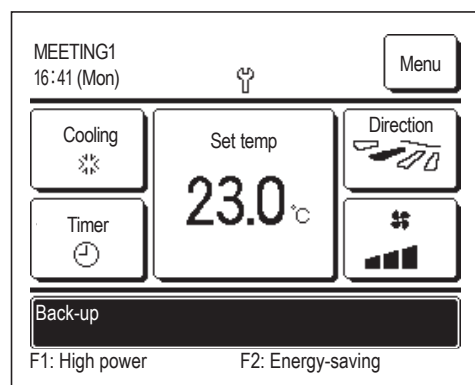

When the “Back-up” is displayed, contact dealer/company shown as the Contact company (page 76) immediately for checking.

■ If the operation is continued without checking, it could result in breakdown.

## 9. After-sale service

---

### ● Inform your dealer

- Model name
- Date of installation
- Failure conditions: As precise as possible.
- Your address, name, and telephone number

### ● Moving

The moving of the unit requires special technology. Consult your dealer.

Necessary expenses for the moving of the unit will be charged.

### ● Repairs after Warranty Period

Consult your dealer. Fare-paying services may be possible at the request of customer.

(The warranty period is one year counting from the date of installation.)

### ● Inquiry about After-sale Service

Contact your dealer or the service contact.